

使用說明書

變頻二合一空氣淨化抽濕機

RAD-DIA17HK

重要提示：

在使用本產品前，請仔細閱讀本手冊，
並妥善保管以備日後參考。

設計和規格如有更改，恕不另行通知。

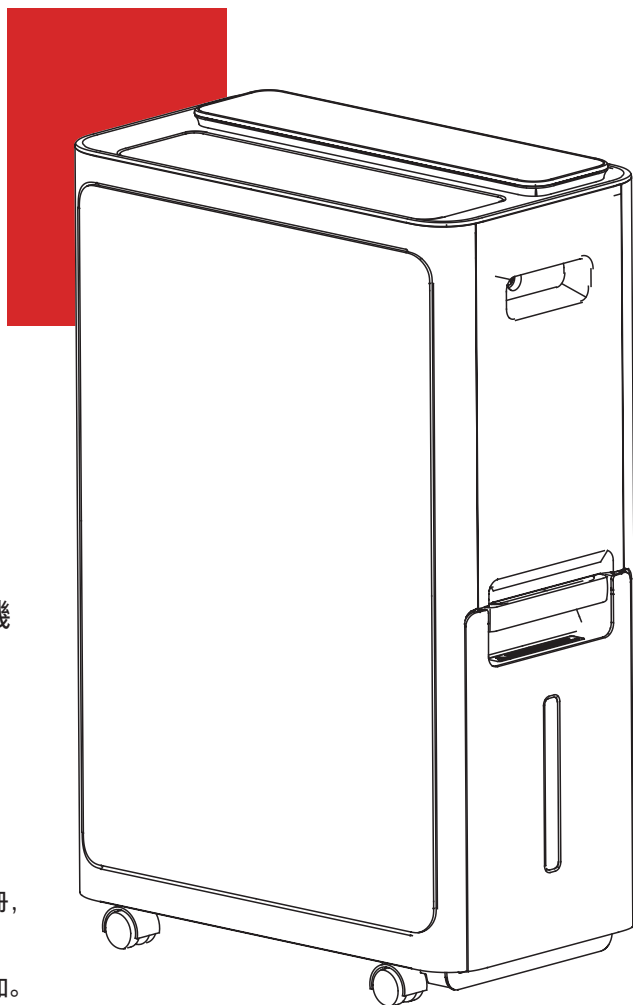

TOSHIBA

目錄

安全注意事項	3
產品簡介	5
各部分名稱	
放置設備位置	
使用產品時	
功能簡介	8
控制面板	
顯示	
電氣工作	
倒掉餘水	10
取出水箱倒水	
連續排水	
保養與維護	12
清潔格柵和機身	
清潔水箱	
清潔空氣過濾網	
規格與淨化數據	15
規格	
淨化數據	
故障排除	16

安全注意事項

必須閱讀警告資訊。

操作和安裝前請閱讀安全注意事項。為了使用者或他人安全及財產保障不受損害，請仔細閱讀並遵守以下內容。因無視說明而導致的不正確操作可能導致人員傷亡或機器損壞。

符號說明

⚠ 警告

表示中等風險，如果未能避免，可能導致死亡或重傷。

⚠ 注意

表示較低風險，如果未能避免，可能導致輕度或中度傷害。

⚠ 警告

- 請勿超過電源插座或連接設備的額定值。
- 請勿通過接上或斷開總電源來操作或停止設備。
- 請勿損壞或使用非提供電源線。
- 請勿自行修改電源線長度或與其他電器共用插座。
- 請勿用濕手插、拔插頭。
- 請勿將設備放置在熱源附近。
- 如果發現奇怪的聲音、氣味或冒煙，請立即斷開電源。
- 切勿自行拆卸或修理設備。
- 清潔前，必須關閉電源並拔下設備插頭。
- 請勿在汽油、苯、稀釋劑等易燃氣體或可燃物附近使用設備。
- 請勿飲用或使用設備排出的水。
- 操作時請勿取出水箱。
- 請勿在狹小空間內使用設備。
- 請勿將設備放在可能會濺濕的地方。
- 請將設備放置在水平、堅固的地板上。
- 請勿用其他物品遮蓋進、排氣口。
- 在有嬰兒、兒童、老年人和對濕度不敏感的人的房間內使用設備時，應小心謹慎。
- 請勿在處理化學品的區域使用設備。
- 請勿將手指或其他異物插入格柵或開口。
- 特別注意並警告兒童上述危險。
- 請勿在電源線上放置重物，注意不要壓迫電源線。
- 請勿攀爬或坐在設備上。
- 務必牢固地裝上過濾網。建議每兩周清洗一次過濾網。如果設備入水，請關閉設備並拔除插座，並聯繫原廠的維修技術人員進行維修。
- 請勿使用延長線。

! 注意

- 8歲及以上的兒童，以及身體、感官或精神有缺陷或缺乏經驗和知識的人在獲得有關安全使用設備的監督或指導，並瞭解所涉及的危險時，可以使用設備。兒童不得玩耍設備，且不得在無人監督的情況下清潔和維護設備（適用於歐洲國家）。
- 該設備不適合身體、感官或精神有缺陷或缺乏經驗和知識的人（包括兒童）使用，除非負責其安全的人員對他們的使用進行了監督或指導。（適用於除歐洲國家以外的其他國家）。
- 如果電源線受到損壞，必須由製造商、其服務代理商或類似合格人員更換，以免發生危險。
- 在清潔或其他維護之前，必須斷開設備與供電主電路的連接。
- 請勿將設備安裝在可能接觸可燃氣體的位置。如果可燃氣體在設備周圍積聚，可能引發火災。
- 如果設備在使用過程中被撞倒，請關閉設備並拔下主電源插頭，檢查設備，確保無損壞。如果懷疑設備損壞，請聯繫技術人員或客戶服務部尋求幫助。雷雨天氣必須切斷電源，以免雷擊損壞設備。
- 請勿用地毯、滑槽或類似覆蓋物覆蓋電線。
- 請勿在家具或電器下方鋪設電線。將電線佈置在遠離交通區域且不會絆倒的地方。
- 請勿在電線或插頭損壞的情況下操作設備，並報廢設備或返回授權服務機構進行檢查和/或維修。
- 為降低火災或觸電風險，請勿將本設備與任何固態調速設備一起使用。
- 必須按照國家佈線規則安裝設備；
- 請聯繫授權維修技師維修或保養設備。
- 不使用設備時請關閉電源。

! 注意

- 製造商銘牌位於設備背面，已寫上設備的電力和其他技術資料。
- 為了減少觸電和火災危險，請確保設備接地正確。電源線配有三腳接地插頭，以防觸電危險。
- 設備應使用正確接上的牆壁插座。如果打算使用的牆壁插座沒有充分接地或受到延時保險絲或斷路器的保護（電氣資料請參見銘牌），請讓合格電工安裝適當的插座。
- 請勿在浴室或洗衣房等潮濕房間運行設備。
- 電器電路板（PCB）設計有保險絲，提供過電流保護。
- 電路板給出了保險絲規格，如：T3.15A/250V（或350V）等。

關於氟化氣體的說明（不適用於使用R290製冷劑的設備）

- 含氟溫室氣體包含在密封設備中。有關含氟溫室氣體的類型、數量和二氧化碳當量（噸）的具體信息（在某些型號上），請參考設備本身的相關標籤。
- 設備安裝、保養、維護和維修必須由經認證的技術人員進行。
- 設備拆卸和回收必須由經認證的技術人員進行。

產品簡介

產品各部件名稱

各部件名稱

注

說明書中的乘有插圖僅適用於解釋用途, 真實情況以機器為準

產品概述

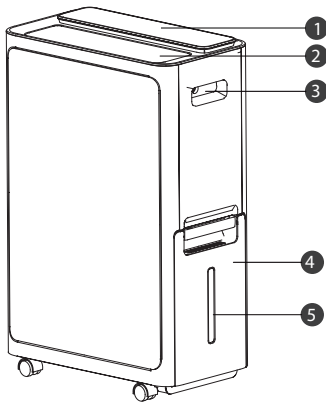

前視圖

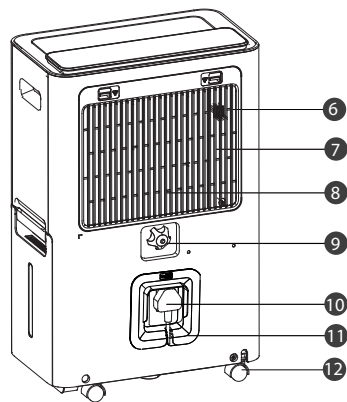

後視圖

- | | | |
|-----------|-------------|-----------|
| ① 控制面板 | ⑥ 進氣格柵 | ⑪ 電源線收納裝置 |
| ② 導風葉 | ⑦ 前置濾網 | ⑫ 腳輪 |
| ③ 把手 (兩側) | ⑧ HEPA空氣過濾網 | |
| ④ 水箱 | ⑨ 排水口 | |
| ⑤ 水位窗口 | ⑩ 電源線及插頭 | |

設計通知

為確保公司產品的最佳性能, 設備設計規範如有更改, 恕不另行通知。

放置設備位置

安全距離要求

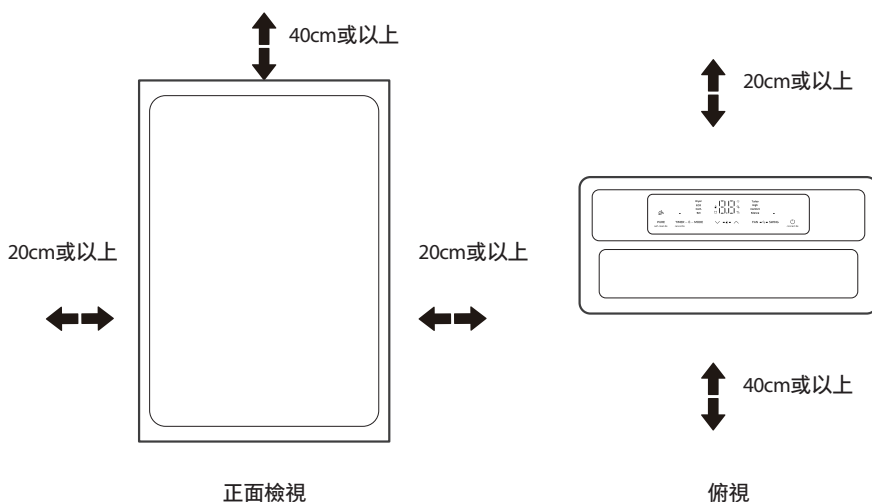

腳輪（位於設備底部四個點的位置）

- 腳輪可自由移動
- 請勿強行將腳輪移動到地毯上，也不得在水箱中有水的情況下移動設備（否則設備可能翻倒，導致水溢出）。

在地下室運行的除濕機對相鄰封閉儲存區域（如壁櫥）的乾燥作用很小或沒有影響，除非該區域有足夠的空氣循環進出。

- 請勿在室外使用設備。
- 該除濕機僅適用於室內住宅，請勿在商業或工業環境中應用。
- 將除濕機放置在光滑、水平的地板上，地板應足夠堅固，以便在水箱水滿時也能支撐設備。
- 裝置四周至少留有20cm的空間，以保持良好的空氣循環（出風口上至少留有40cm的空氣空間）。
- 將裝置放置在溫度不低於5°C（41°F）的區域。當溫度低於5°C（41°F）時，線圈可能會結霜，從而降低性能。
- 裝置應置於遠離乾衣機、加熱器或散熱器處。
- 存放書籍或貴重物品時，可使用本裝置防止受潮損壞。
- 在地下室使用除濕機，以防受潮損壞。
- 除濕機必須在封閉區域操作才能達到最佳效果。使用時請關閉房間的所有門、窗和其他外部開口。

使用產品時

產品使用前準備。

本裝置的設計工作環境為5°C/41°F至32°C/90°F，相對濕度為30%（RH）至80%（RH）之間。

- 如果裝置已經關閉，需要快速重新打開，請等待大約三分鐘以恢復正確操作。
- 請勿將除濕機連接到也用於其他電器的多孔插座上。
- 選擇合適的位置，確保可以方便地使用電源插座。
- 將裝置插入帶接地連接的電源插座。
- 確保水箱安裝正確，否則裝置將無法正常運行。

注

水箱中的水達到一定水平時，請小心移動設備，以免設備翻倒。

附件

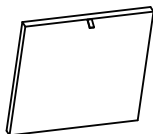

HEPA空氣過濾網（1個）

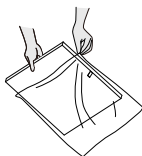

注意：在使用HEPA空氣過濾網前，必須去除塑膠密封膜。

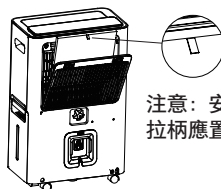

注意：安裝過濾網時拉柄應置於外側的上端。

功能簡介

操作顯示

控制面板

注

以下控制面板僅供說明。真實情況以機器為準。
設備開機或關機，或者模式切換時，因為壓縮機頻率增減，會有輕微明顯的壓縮機運轉聲音。這屬於正常現象。

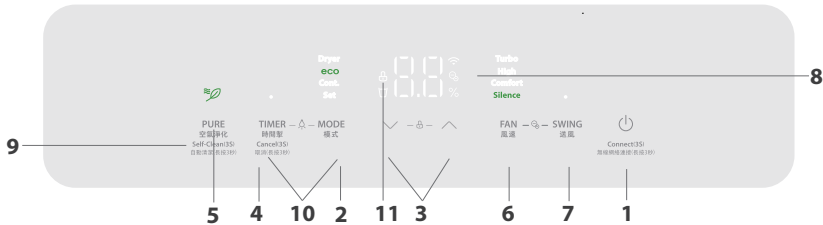

指示器	功能	指示器	功能
	無線燈		水滿提示燈
	離子燈		淨化模式燈
	顯示器開/關燈		童鎖燈

1. 啟動/關閉按鈕

按鍵打開或關閉除濕機。

注

當壓縮機啟動或停止運行時，裝置可能會發出很大的聲音，屬正常現象。每次開機後，默認開啟負離子功能。

2. 模式功能

每按一次模式鍵，可在節能模式 - 連續 - 設置 - 乾衣 - 節能模式之間循環。

注

切換模式或啟動時，將顯示設定濕度5秒。5秒後切換回環境濕度顯示。

節能模式

按下模式按鈕，選擇節能模式。在智慧除濕模式下，可通過上、下按鍵調節濕度。濕度範圍為35%至85%。預設值為60%。

注

選擇此功能時，風速調節不可用。

設置模式

按下模式按鈕，選擇設置模式。
選擇此模式時，將顯示設定濕度5秒。
5秒後切換回環境濕度顯示。

連續運行模式

按下模式按鈕並選擇連續運行模式。

注

選擇此模式時，開啟連續除濕功能並伴有高速送風模式。在此模式下，無法調節設定濕度和風速。

3. 上、下鍵

濕度設定控制按鈕

在設置除濕模式下，可設置的濕度水準範圍為35%RH（相對濕度）至85%RH（相對濕度），以5%的增量進行設置。長按按鈕，濕度持續下降。長按按鈕，濕度持續上升。

4. 定時功能

- 按下計時器按鈕，計時器指示燈亮起。表示自動啟動或自動停止程式已啟動。
對於某些裝置，繼續按下計時器按鈕將取消計時器設置。
- 長按上或下按鈕，以0.5小時為增量更改自動時間，最多可更改10小時，然後以1小時為增量更改自動時間，最多可更改24小時。控制系統將倒計時直到啟動為止的剩餘時間。
- 所選時間將在5秒後顯示，裝置開機時系統將自動恢復顯示之前的濕度設置或房間濕度。
裝置關閉時，無顯示。
- 在任何時間開啟或關閉本裝置，或者將計時器設置調整為0.0，則自動啟動/停止定時程式將會取消。

5. 空氣淨化功能

啟動/關閉時，按此鍵進入淨化功能。該功能開啟後，將顯示3秒鐘的“開啟空氣”。

6. 送風功能

按此鍵在風速模式間切換→高→舒適→靜音→強勁設置風速。

7. 擺動功能

按下此按鍵可開啟或關閉擺動功能。

8. 離子功能

同時按下送風和擺動鍵並持續3秒，開啟/關閉負離子功能。

注

打開淨化功能時，可以開啟/關閉該功能。

9. 清潔功能

按下淨化鍵並持續3秒，打開/關閉此功能。

10. 顯示

按定時鍵和模式鍵並持續3秒可開啟/關閉數字顯示功能。

11. 兒童鎖功能

長按上、下鍵3秒，可鎖定或解鎖控制面板。

顯示

顯示錯誤代碼和保護代碼：裝置可能停止運行或繼續安全運行。如果出現錯誤代碼，請等待10分鐘左右。問題可能會自行解決。如果沒有，斷開電源，然後重新連接。打開裝置。如果問題仍然存在，請斷開電源並聯繫最近的客戶服務中心。室內機視窗顯示錯誤碼，錯誤碼以以下字母開頭：EH (xx)、EL (xx)、EC (xx)、PH (xx)、PL (xx)、PC (xx)

更多功能

無線操作（部分機型）：

- 首次使用WiFi功能時，長按POWER鍵3秒，啟動WiFi連接模式。LED顯示幕顯示“AP”，表示您可以設置WiFi連接。如果在8分鐘內連接（路由器）成功，裝置將自動退出WiFi連接模式，無線指示燈點亮。如果在8分鐘內連接失敗，裝置將自動退出WiFi連接模式。（詳細WiFi功能請參閱Smart Kit 說明書）

電氣工作



警告：
在進行任何電氣或接線工作之前，請關閉系統的主電源。



注：圖表僅作說明之用。您的機器可能略有不同。以實際形狀為準。

倒掉餘水

當您的產品已經使用一段時間時。

清除餘水有兩種方法。

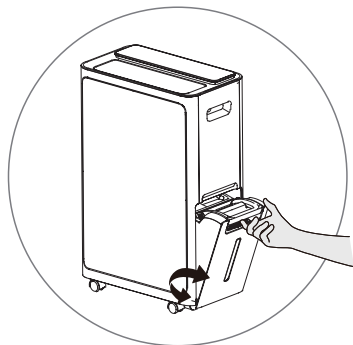

類型1:

取出水箱, 倒掉餘水

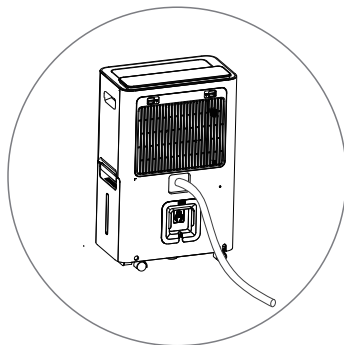

類型2:

連續排水

註: 排水管需另外購買
(內直徑13.5mm, 外直徑16.5mm)

取出水箱, 倒掉餘水

注

- 將取出水箱時, 請勿將設備放置在任何電氣部件上, 因為底部可能潮濕。
- 取下設備水箱後, 請勿將設備放置在不平整的表面上。
- 裝上水箱後, 請確保設備正確就位。
- 如在操作過程中取下水箱, 顯示幕上的空水箱圖示將閃爍, 且設備停止工作, 直至水箱放回原位。

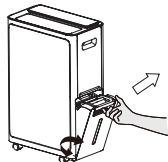

1

拉出水箱。

抓住手柄, 拉出水箱。

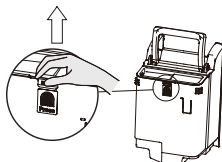

2

打開蓋子。

抓住扣環往上拉。

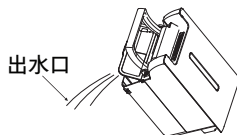

3

倒水。

從出水口倒水。

連續排水

注

- 確保軟管牢固，無瀉出。
- 將軟管末端放入排水口，確保軟管末端處於水平或向下狀態，使水流暢通。

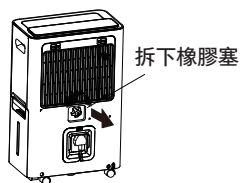

1

拆下橡膠塞。

逆時針轉動連續出口蓋，將其拆下。

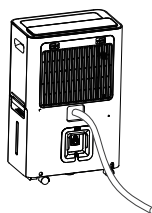

2

連接排水軟管。 (需自行購買)

連接排水管 (需自行購買)

保養與維護

如何清潔和維護您的產品。

清潔前，務必關掉設備並從電源插座拔掉插座。

清潔格柵和主機殼

- 使用水和溫和的清潔劑進行清潔。請勿使用漂白劑或磨料。
- 請勿將水直接濺到主機上。否則可能會導致觸電、絕緣退化或裝置生銹。
- 進氣格柵和出氣格柵容易弄髒，請使用真空附件或刷子進行清潔。

清潔水箱

- 建議每隔幾周，清潔水箱一次。用清水和溫和的清潔劑將桶部分注滿。倒空沖洗乾淨。

注

請勿使用洗碗機清洗水箱。清潔後，水箱必須放置到位並牢固固定，以便除濕機運行。

1. 向內按壓手柄一側，向上抬起。
2. 按下水箱中間的指紋位置，蓋上水箱蓋。
3. 握住水箱蓋內側，向上提起整個箱蓋。將水箱各部件清洗乾淨，自然晾乾後按上述步驟重新安裝。

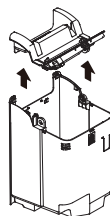
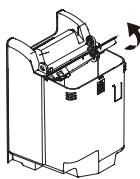
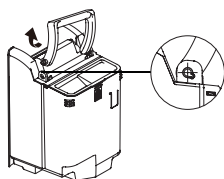

注

安裝手柄時，請在手柄兩側對應安裝孔上安裝卡扣。否則，手柄無法正確安裝和復位。

清潔空氣過濾網

應至少每兩週檢查和清潔一次前格柵後面的空氣過濾網，也可因自身需要更頻繁地進行清潔。

注

請勿將過濾網放進洗碗碟機進行清洗。

拆卸：

- 按下過濾網上的扣子，向外拉，然後取出。
- 用溫水清洗過濾網。更換過濾網前，沖洗並晾乾。

安裝：

- 將空氣濾清網和高效空氣過濾網從下往上插入裝置。
- 建議每6個月更換一次高效空氣過濾網。

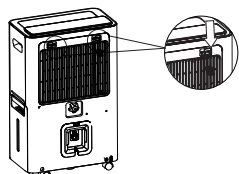

1 拆卸後格柵。

2 使用HEPA空氣過濾網。 朝外安裝，以便更換。

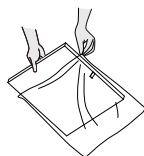

注：在使用HEPA
空氣過濾網前，
必須去除塑膠密封膜。

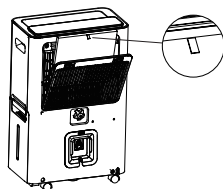

注意

請勿在沒有過濾網的情況下操作除濕機，因為污垢和絨毛會堵塞除濕機並降低其性能。

注

可以用無油布擦拭機櫃和正面，或者用經過溫水和中性液態餐具清潔劑浸泡過的布進行清洗。徹底沖洗並擦乾。切勿在機櫃正面使用具有刺激性的清潔劑、蠟或拋光劑。擦拭控制裝置周圍之前，務必扭乾抹布上多餘的水。控制裝置內或周圍的水過多可能會損壞裝置。

排水管清潔

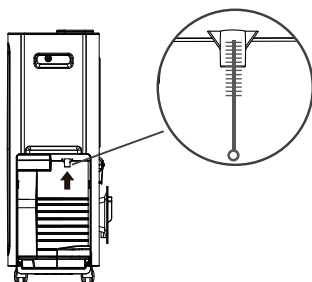

清潔水箱排水管

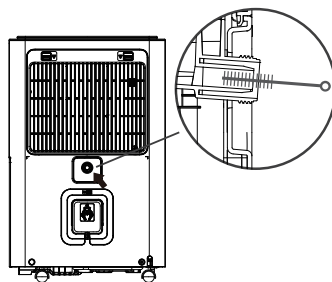

清理永久排水管

- 用直徑小於10mm的吸管刷插入排水管，上下刮擦，防止污垢在孔內堆積。
- 排水管外部可用棉布擦拭。

長時間不使用本裝置時

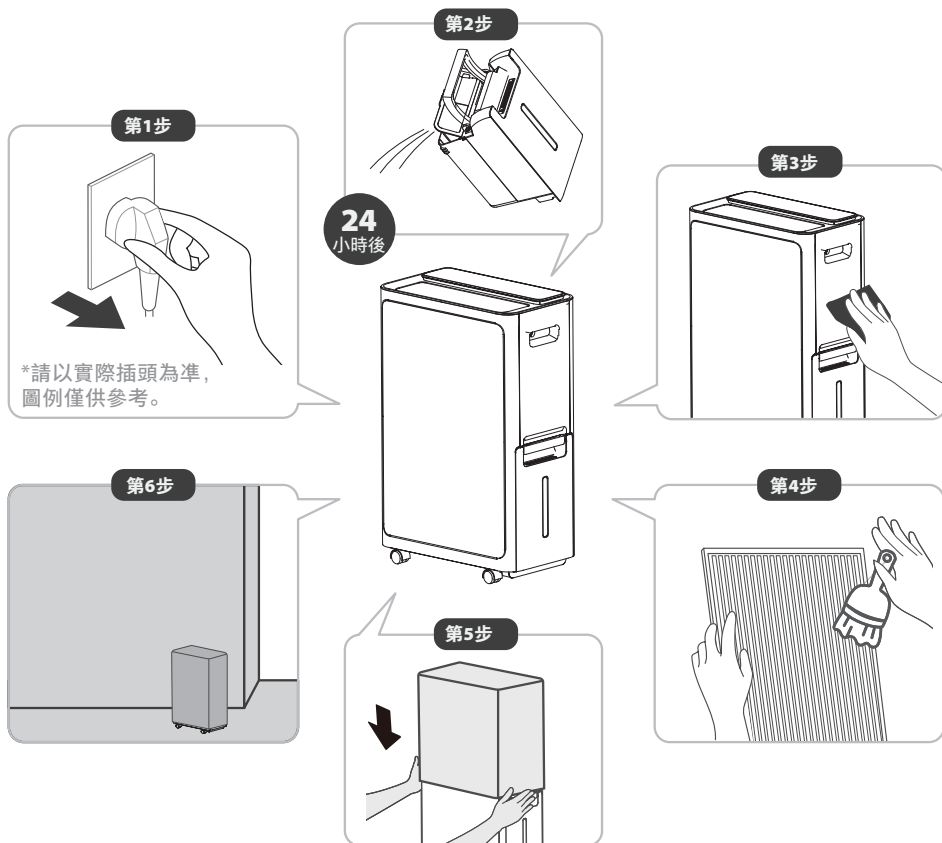

- 第1步：關機後拔掉產品插頭。
- 第2步：拔掉電源24小時後將水桶清空。
- 第3、4步：清潔主機、水桶和空氣過濾網。
- 第5步：用塑膠袋蓋住裝置。
- 第6步：將裝置直立存放於乾燥、通風良好的地方。

規格與淨化數據

規格

型號	RAD-DIA17HK
顏色	白色
產品尺寸(寬*深*高)(mm)	420*265*662
抽濕量	能源效益標準: 17升/天 (26.7℃ 60%) 廠方標準: 28升/天 (30℃ 80%)
電源	AC 220V/50Hz
能源效率	13A/250V

淨化數據

項目	淨化
檢測實驗室	深圳天祥質量技術服務有限公司廣州分公司
檢測方法	符合ANSI/AHAM AC-1-2020
抑制方法	產生的負離子比正離子多，能吸附灰塵和細菌
抑制目標	煙、粉塵、花粉、細顆粒物 (PM2.5)
檢測結果	煙淨化率 (每分鐘立方英尺) : 51 粉塵淨化率 (每分鐘立方英尺) : 64.2 花粉淨化率 (每分鐘立方英尺) : 97.1 細顆粒物2.5淨化率 (每分鐘立方英尺) : 57.2
報告編號	230921139GZU-001

項目	殺菌
檢測實驗室	深圳天祥質量技術服務有限公司廣州分公司
檢測方法	符合GB/T 18801-2022和GB 21551.3-2010 消毒技術規範 (2002年版, 中華人民共和國衛生部) -2.1.3
抑制方法	正負離子結合產生新的正負離子，正負離子中和放電具有一定的殺菌能力
抑制目標	白色葡萄球菌8032、金黃色葡萄球菌ATCC 6538和大腸埃希氏菌8099
檢測結果	白色葡萄球菌8032殺滅率: 99.95% 金黃色葡萄球菌ATCC 6538殺滅率: 99.95% 大腸埃希氏菌8099殺滅率: 99.95%
報告編號	230921139GZU-002

項目	消毒
檢測實驗室	深圳天祥質量技術服務有限公司廣州分公司
檢測方法	符合GB/T 18801-2022和GB 21551.3-2010 消毒技術規範 (2002年版, 中華人民共和國衛生部) -2.1.3
抑制方法	正負離子結合產生新的正負離子，正負離子中和放電具有一定的殺菌能力
抑制目標	甲型流感病毒A/PR/8/34株
檢測結果	甲型流感病毒A/PR/8/34株殺滅率: 99.99%
報告編號	230921139GZU-002

故障排除

在呼叫服務之前，請先自行查看下面的情況。

問題	檢查內容
裝置未啟動	確保除濕機插頭完全插入插座。 檢查廠用保險絲/斷路器箱。 水箱位置不對。
除濕機未按要求乾燥空氣	未能留出足夠的時間去除水分。 確保沒有窗簾、百葉窗或傢俱擋住除濕機的正面或背面。 溫度控制可能設置得不夠低。 檢查所有門、窗和其他開口是否牢固關閉。 室溫過低，低於5°C（41°F）。 房間裡有煤油加熱器或散發水蒸氣的東西。
裝置運行時噪音大	空氣過濾網堵塞。 裝置傾斜，而非正常的直立。 地板表面不平整。
線圈結霜	除濕機具有自動除霜功能。屬正常現象。
地板上有水	軟管與連接器的連接或軟管連接可能鬆動。
顯示幕上出現EH（xx）、EL（xx）、EC（xx）、PH（xx）、PL（xx）、PC（xx）	這些是錯誤代碼和保護代碼。參見“控制面板功能”一節。

#DetailsMatter

USER MANUAL

Inverter Compressor 2 in 1
Air Purifying Dehumidifier
RAD-DIA17HK

Warning notices: Before using this product,
please read this manual carefully and keep
it for future reference.

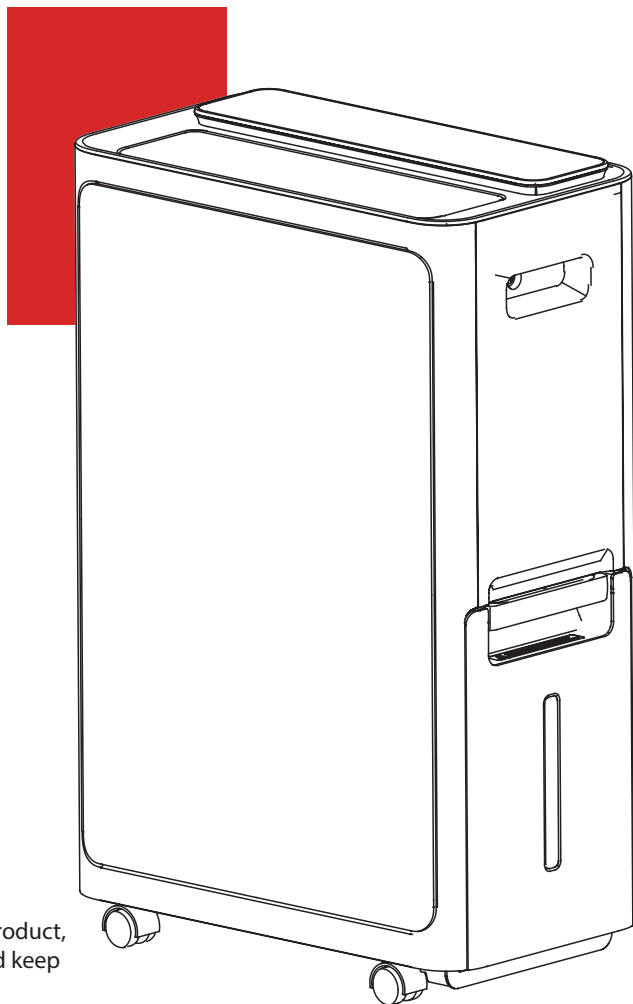

TOSHIBA

SAFETY PRECAUTIONS.....	3
GET TO KNOW YOUR PRODUCT.....	6
Identification of parts	
Positioning the unit	
Accessories	
GET TO KNOW THE FEATURES.....	9
Control Panel	
DUMP THE COLLECTED WATER.....	12
Bucket drainage	
Continuous drainage	
CARE AND MAINTENANCE.....	14
Clean the Grill and Case	
Clean the bucket	
Clean the air filter	
SPECIFICATIONS AND PURIFICATION DATA.....	17
Specifications	
Purification data	
TROUBLESHOOTING.....	18

SAFETY PRECAUTIONS

Must read the warning message.

Read Safety Precautions Before Operation and Installation To prevent death or injury to the user or other people and property damage, the following instructions must be followed. Incorrect operation due to ignoring of instructions may cause death, harm or damage.

Explanation of Symbols

WARNING

The signal word indicates a hazard with a medium level of risk which, if not avoided, may result in death or serious injury.

CAUTION

The signal word indicates a hazard with a low degree of risk which, if not avoided, may result in minor or moderate injury.

WARNING

- Do not exceed the rating of the power outlet or connection device.
- Do not operate or stop the unit by switching on or off the power.
- Do not damage or use an unspecified power cord.
- Do not modify power cord length or share the outlet with other appliances.
- Do not insert or pull out plug with wet hands.
- Do not place the unit near a heat source.
- Disconnect the power if strange sounds, smell, or smoke comes from it.
- You should never try to take apart or repair the unit by yourself.
- Do not use the machine near flammable gas or combustibles, such as gasoline, benzene, thinner, etc.
- Do not drink or use the water drained from the unit.
- Do not take the water bucket out during operation.
- Do not use the unit in small spaces.
- Do not put in places where water may splash onto the unit.
- Place the unit on a level, sturdy section of the floor.
- Do not cover the intake or exhaust openings with cloths or towels.
- Care should be taken when using the unit in a room with the following persons: infants, children, elderly people, and people not sensitive to humidity.
- Do not use in areas where chemicals are handled.
- Never insert your finger or other foreign objects into grills or openings.
- Take special care to warn children of these dangers.
- Do not place heavy object on the power cord and take care so that the cord is not compressed.
- Do not climb up on or sit on the unit.
- Always insert the filters securely. Clean filter once every two weeks. If water enters the unit, turn the unit off and disconnect the power, contact a qualified service technician.
- Do not use extension cords.

 **CAUTION**

- This appliance can be used by children aged from 8 years and above and person with reduced physical, sensory or mental capabilities or lack of experience and knowledge if they have been given supervision or instruction concerning use of the appliance in a safe way and understand the hazards involved. Children shall not play with the appliance. Cleaning and user maintenance shall not be made by children without supervision. (be applicable for the European Countries)
- This appliance is not intended for use by persons (including children) with reduced physical, sensory or mental capabilities or lack of experience and knowledge, unless they have been given supervision or instruction concerning use of the appliance by a person responsible for their safety. (be applicable for other countries except the European Countries)
- If the supply cord is damaged, it must be replaced by the manufacturer, its service agent or similarly qualified persons in order to avoid a hazard.
- Prior to cleaning or other maintenance, the appliance must be disconnected from the supply mains.
- Do not install the appliance in a location that may be exposed to combustible gas. If combustible gas accumulates around the unit, it may cause fire.
- If the appliance is knocked over during use, turn off the unit and unplug it from the main power supply immediately. Visually inspect the unit to ensure there is no damage. If you suspect the unit has been damaged, contact a technician or customer service for assistance. In a thunderstorm, the power must be cut off to avoid damage to the machine due to lightning.
- Do not run cord under carpeting. Do not cover cord with throw rugs, runners, or similar coverings.
- Do not route cord under furniture or appliances.
Arrange cord away from traffic area and where it will not be tripped over.
- Do not operate unit with a damaged cord or plug. Discard unit or return to an authorized service facility for examination and/or repair.
- To reduce the risk of fire or electric shock, do not use this fan with any solid-state speed control device.
- The appliance shall be installed in accordance with national wiring regulations.
- Contact the authorised service technician for repair or maintenance of this unit.
- Turn off the product when not in use.

Note about Fluorinated Gases (Not applicable to the unit using R290 Refrigerant)

- Fluorinated greenhouse gases are contained in hermetically sealed equipment. For specific information on the type, the amount and the CO₂ equivalent in tonnes of the fluorinated greenhouse gas (on some models), please refer to the relevant label on the unit itself.
- Installation, service, maintenance and repair of this unit must be performed by a certified technician.
- Product uninstallation and recycling must be performed by a certified technician.

 **CAUTION**

- The manufacturer's nameplate is located on the rear panel of the unit and contains electrical and other technical data specific to this unit.
- Be sure the unit is properly grounded. To minimize shock and fire hazards, proper grounding is important. The power cord is equipped with a three-prong grounding plug for protection against shock hazards.
- Your unit must be used in a properly grounded wall receptacle. If the wall receptacle you intend to use is not adequately grounded or protected by a time delay fuse or circuit breaker (please refer to the nameplate for the electrical data), have a qualified electrician install the proper receptacle.
- Do not operate your appliance in a wet room such as a bathroom or laundry room.
- The unit's circuit board (PCB) is designed with a fuse to provide overcurrent protection.
- The specifications of the fuse are printed on the circuit board, such as: T3.15A/250V (or 350V), etc.

GET TO KNOW YOUR PRODUCT

Name of each component of the product

Identification of parts

NOTE

All the illustrations in the manual are for explanation purpose only. Your machine may be slightly different.

Product overview

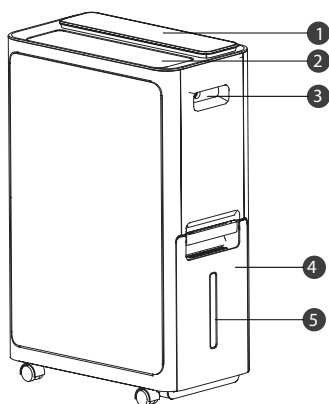

Front View

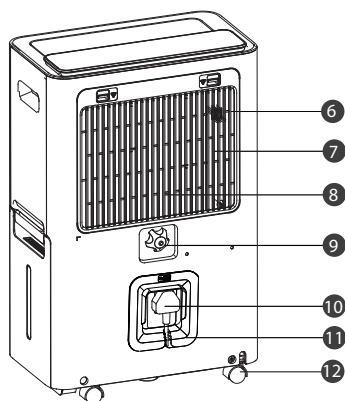

Back View

- | | | | | | |
|---|---------------------|----|---------------------|----|---------------------|
| 1 | control panel | 6 | rear grille | 11 | hook for power cord |
| 2 | air outlet louver | 7 | air filter | 12 | caster |
| 3 | handle (both sides) | 8 | HEPA filter | | |
| 4 | water tank | 9 | continuous outlet | | |
| 5 | water level window | 10 | power cord and plug | | |

Design Notice

In order to ensure the optimal performance of our products, the design specifications of the unit are subject to change without prior notice.

Positioning the unit

Safe distance requirements

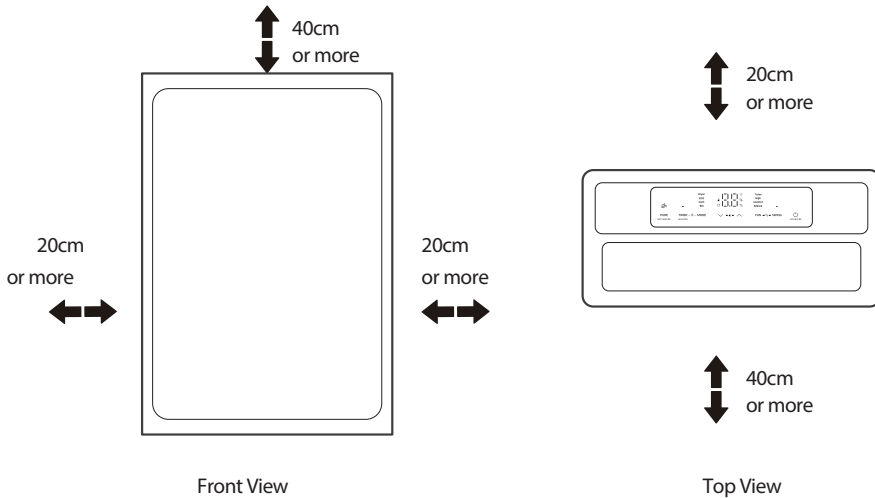

Get To Know
Your Product

Casters (At four points on the bottom of unit)

- Casters can move freely.
- Do not force casters to move over carpet, nor move the unit with water in the bucket. (The unit may tip over and spill water.)

A dehumidifier operating in a basement will have little or no effect in drying an adjacent enclosed storage area, such as a closet, unless there is adequate circulation of air in and out of the area.

- Do not use outdoors.
- This dehumidifier is intended for indoor residential applications only. This dehumidifier should not be used for commercial or industrial applications.
- Place the dehumidifier on a smooth, level floor strong enough to support the unit with a full bucket of water.
- Allow at least 20cm of air space on all sides of the unit for good air circulation (at least 40cm of air space on air outlet).
- Place the unit in an area where the temperature will not fall below 5° C (41° F). The coils can become covered with frost at temperatures below 5° C (41° F), which may reduce performance.
- Place the unit away from the clothes dryer, heater or radiator.
- Use the unit to prevent moisture damage anywhere books or valuables are stored.
- Use the dehumidifier in a basement to help prevent moisture damage.
- The dehumidifier must be operated in an enclosed area to be most effective.
- Close all doors, windows and other outside openings to the room.

When using your product

Preparations for product use.

- This unit is designed to operate with a working environment between 5°C/41°F and 32°C/90°F, and between 30%(RH) and 80%(RH).
- If the unit has been switched of and needs to be switched on again quickly, allow approximately three minutes for the correct operation to resume.
- Do not connect the dehumidifier to a multiple socket outlet, which is also being used for other electrical appliances.
- Select a suitable location, making sure you have easy access to an electrical outlet.
- Plug the unit into a electrical socket-outlet with earth connection.
- Make sure the Water bucket is correctly fitted otherwise the unit will not operate properly.

NOTE

When the water in the bucket reaches to a certain level, please be careful to move the machine to avoid it falling down.

Accessories

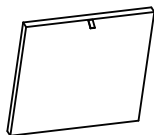

HEPA filter(1 pc)

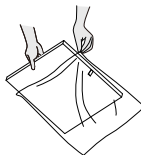

NOTE: Be sure to remove the plastic sealing film before using HEPA filter.

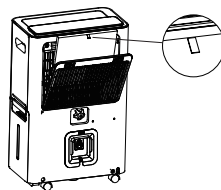

GET TO KNOW THE FEATURES

Operation Display

Control Panel

NOTE

The following control panels are for explanation purpose only. The control panel of the unit you purchased may be slightly different according to the models.
When the machine is turned on or of, or when the mode is switched on, there will be a slightly obvious sound of compressor operation, because the compressor frequency is increased or decreased, it is normal.

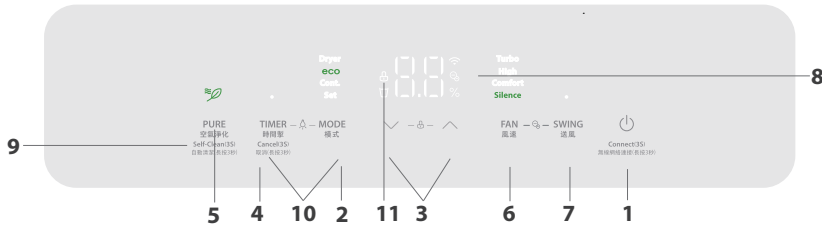

Indicator	Function	Indicator	Function
	Wireless light		Water filled lamp light
	Fresh light		Purification mode light
	Display ON /OFF light		Child lock light

1.POWER ON/OFF button

Press to turn the dehumidifier on or of.

NOTE

When the compressor startups or stops running, the unit may make a loud voice, it is normal.
After each turn on, The negative ion function is enabled by default.

2.MODE Function

Each time you press the MODE button, you can cycle between:

ECO -Set-Cont.-Dryer-ECO mode.

NOTE

When switching mode or power on, it will display the setting humidity for 5 seconds.
After 5 seconds, it will switch back to the ambient humidity display.

ECO MODE

Press the Mode button and select ECO mode.
In Smart dehumidification mode, you can press the UP and DOWN buttons to adjust the humidity.
The humidity range is 35% to 85%. The default value is 60%.

NOTE

When this function is selected, FAN speed regulation is not available.

SET MODE

Press the Mode button and select Set mode. When this mode is selected, it will display the setting humidity for 5 seconds. After 5 seconds, it will switch back to the ambient humidity display.

CONT. MODE

Press the Mode button and select Cont. mode.

NOTE

When this function is selected, the setting humidity will not be displayed. In this mode, the setting humidity cannot be adjusted.

DRYER MODE

Press the Mode button and select Dryer mode.

NOTE

When this mode is selected, the continuous dehumidification function is enabled and the high speed FAN mode is accompanied. Setting humidity and FAN speed cannot be adjusted in this mode.

3.Up and Down buttons

Humidity Set Control buttons

In Setting dehumidifying mode, The humidity level can be set within a range of 35%RH(Relative Humidity) to 85%RH(Relative Humidity) in 5% increments. Press and hold the \vee button the humidity drop continuously. Press and hold the \wedge button the humidity rise continuously.

4.TIMER Function

- Press Timer button, the TIMER indicator light illuminates. It indicates the Auto Start or Auto Stop program is initiated. For some units, continuing to press the Timer button will cancel the timer settings.
- Press or hold the UP or DOWN button to change the Auto time by 0.5 hour increments, up to 10 hours, then at 1 hour increments up to 24 hours. The control will count down the time remaining until start.

- The selected time will register in 5 seconds, and the system will automatically revert back to display the previous humidity setting or room humidity when the unit is on. When the unit is off, there is no display.
- Turning the unit ON or OFF at any time or adjusting the timer setting to 0.0 will cancel the Auto Start/Stop timed program.

5.PURIFY Function

Power ON/OFF, press this button to enter the PURIFY function.

After the function is on, 3 seconds 'On' will be displayed.

6.FAN Function

Press this button to switch between Turbo \rightarrow High \rightarrow Comfort \rightarrow Silence \rightarrow Turbo Sets the FAN speed.

7.SWING Function

Press this button to turn on or of the SWING function.

8.ION Function

Press the FAN and SWING buttons at the same time and continue for 3 seconds to enable/disable the negative ion function.

NOTE

When you open the PURIFY Function, you can switch this function ON/OFF.

9.Self-clean- Function

Turn this function ON/OFF by press the PURIFY button for 3 seconds.

10.DISPLAY

In the startup state, press TIMER and MODE keys and continue for 3 seconds to turn on/of the digital display function.

11.Child Lock Function

Press Up and DOWN buttons for 3 seconds to lock or unlock the control panel.

Display

Shows Error codes and protection code: The unit may stop operation or continue to run safely. If the error codes appear, wait for about 10 minutes. The problem may resolve itself. If not, disconnect the power, then connect it again. Turn the unit on. If the problem persists, disconnect the power and contact your nearest customer service center. Error code appears and begins with the letters as the following in the window display of indoor unit: EH(xx), EL(xx), EC(xx), PH(xx), PL(xx), PC(xx)

Electronic Work



WARNING:

BEFORE PERFORMING ANY ELECTRICAL OR WIRING WORK, TURN OFF THE MAIN POWER TO THE SYSTEM.

More features

Wireless operation(on some models):

- For the first time to use Wifi function, press the POWER button for 3 seconds to initiate the Wifi connection mode. The LED DISPLAY shows 'AP' to indicate you can set Wifi connection. If connection (router) is successful within 8 minutes, the unit will exit Wifi connection mode automatically and the Wireless indicator illuminates. If connection is failure within 8 minutes, the unit exits Wifi connection mode automatically.

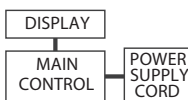

NOTE: The cographs are for explanation purpose only. Your machine may be slightly diferent. The actual shape shall prevail.

DUMP THE COLLECTED WATER

When your product has been in use for a while.

There are two ways to remove collected water.

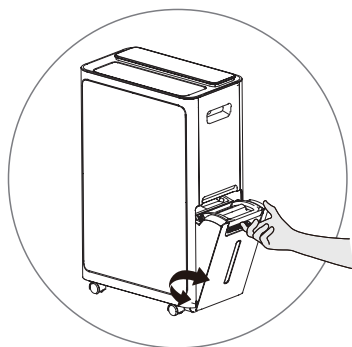

Type 1:

Bucket drainage

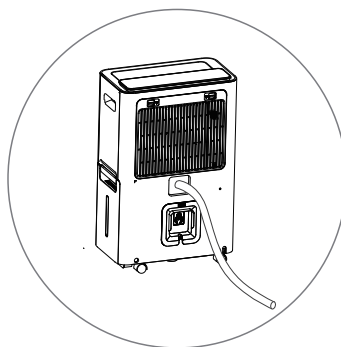

Type 2:

Continuous drainage

Note: The drainage hose is optional
(Inner diameter) \varnothing 13.5mm
(Outer diameter) \varnothing 16.5mm

Bucket drainage

NOTE

- When you remove the bucket from the unit do not set the unit on any electrical components as the bottom may be wet.
- Do not set the unit on an uneven surface after removing it from the bucket.
- Ensure the unit is seated properly after returning into the bucket.
- If the bucket is removed during operation, empty bucket icon on the display will blink and stop working until the bucket is seated.

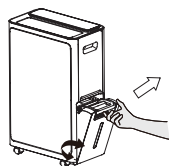

1

Pull out the bucket.

Grab the handle and pull out the tank.

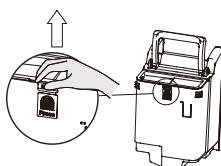

2

Open the cover.

Grab the clasp and pull up.

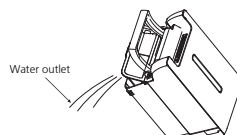

3

Pour the water out.

Pour the water out.
(from water outlet)

Continuous drainage

NOTE

- Make sure the hose is secure so there are no leaks.
- Place the end of the hose into the drain outlet and make sure the end of the hose is level or downwards to let the water flow smoothly .

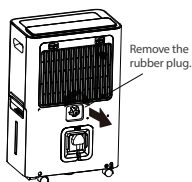

1

Remove the rubber plug.

Remove the continuous outlet cover by turning it counterclockwise

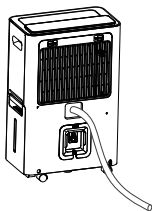

2

Attach the drain hose. (not include)

Connect drainpipes (not included)

CARE AND MAINTENANCE

How to clean & maintenance your product.

Turn off the dehumidifier of and disconnect the plug from the power source before cleaning.

Clean the Grill and Case

- Use water and a mild detergent. Do not use bleach or abrasives.
- Do not splash water directly onto the main unit. Doing so may cause an electrical shock, cause the insulation to deteriorate, or cause the unit to rust.
- The air intake and outlet grilles get soiled easily, so use a vacuum attachment or brush to clean.

Clean the bucket

- Suggest to clean the bucket thoroughly every few weeks. Partially fill the bucket with clean water and mild detergent. Swish it around in the bucket, empty and rinse.

NOTE

Do not use a dishwasher to clean the bucket. After clean, the bucket must be in place and securely seated for the dehumidifier to operate.

1. Press one side of the handle inward and lift it up.
2. Press the fingerprint in the middle of the water tank to make the water tank cover up.
3. Hold the inside of the tank cover and lift the whole tank cover upward. Clean the components of the tank, dry them naturally, and then reinstall them according to the above steps.

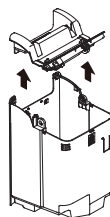
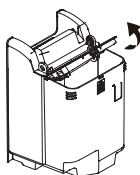
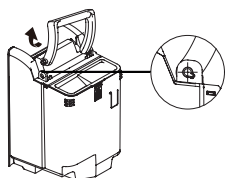

NOTE

When installing the handle, install the clasps on both sides of the handle corresponding to the mounting holes. Otherwise, the handle cannot be properly installed and reset.

Clean the air filter

The air filter behind the front grille should be checked and cleaned at least every two weeks or more often if necessary.

NOTE

DO NOT CLEAN THE FILTER IN A DISHWASHER.

To remove:

- Press down the tab on the filter and pull it outward, then take it out.
- Clean the filter with warm, soapy water. Rinse and let the filter dry before replacing it. Do not clean the filter in a dishwasher.

To attach:

- Insert the air filter and HEPA filter into the unit from underside to upside.
- HEPA filter is recommended to be replaced once every 6 months.

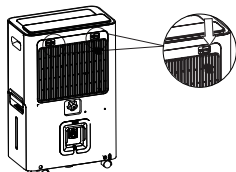

1 Remove the rear grille.

2 Install HEPA filter with handle strap. Mount outwards for replacement.

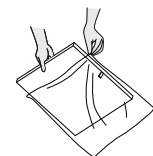

NOTE: Be sure to remove the plastic sealing film before using HEPA filter.

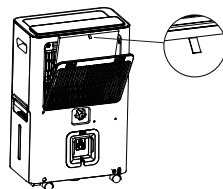

CAUTION

DO NOT operate the dehumidifier without a filter because dirt and lint will clog it and reduce performance.

NOTE

The cabinet and front may be dusted with an oil-free cloth or washed with a cloth dampened in a solution of warm water and mild liquid dishwashing detergent. Rinse thoroughly and wipe dry. Never use harsh cleansers, wax or polish on the cabinet front. Be sure to wring excess water from the cloth before wiping around the controls.

Excess water in or around the controls may cause damage to the unit.

Drain clean

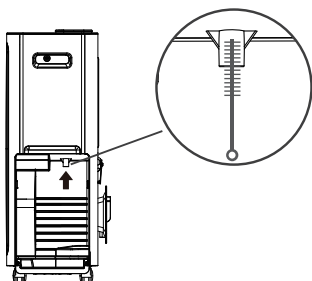

Clean the bucket drain

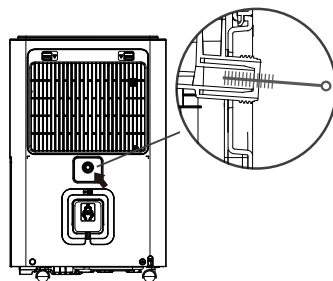

Clean the permanent drain

- Insert a straw brush with a diameter smaller than 10mm into the drain, scrape up and down to prevent dirt from accumulating inside the hole.
- The outside of the drain can be wiped with a cotton cloth.

When not using the unit for long time periods

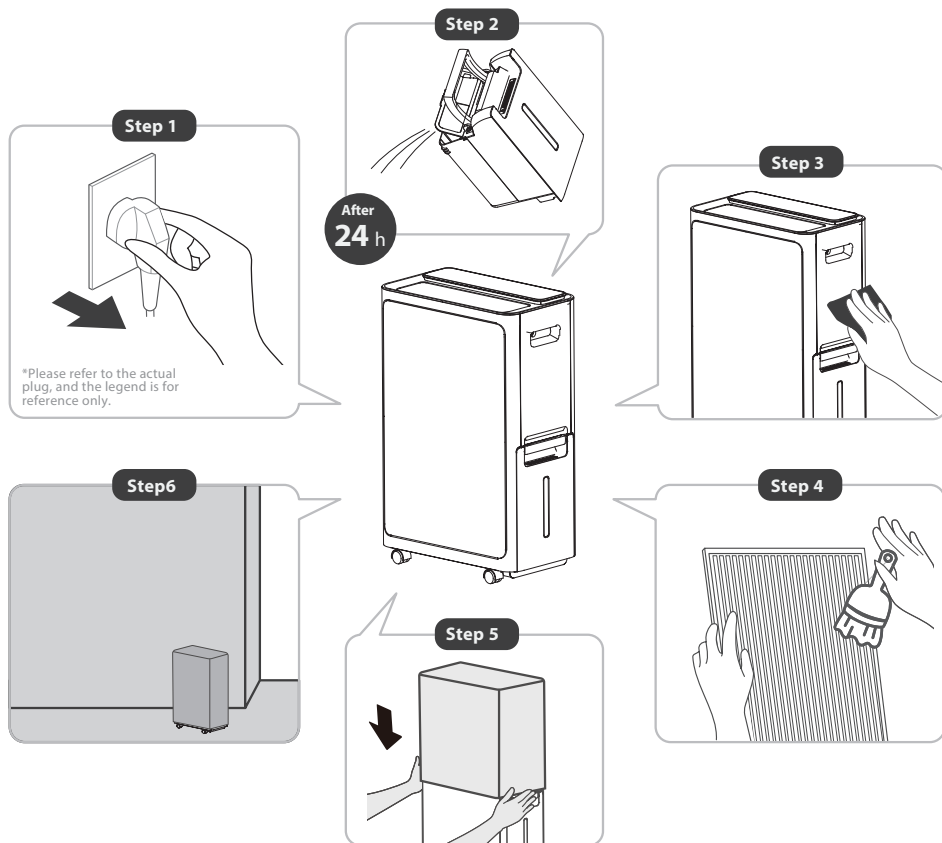

- Step 1: Unplug the product, after turning of the unit.
- Step 2: Empty the bucket after 24 hours of unplugging.
- Step 3&4: Clean the main unit, water bucket and air filter.
- Step 5: Cover the unit with a plastic bag.
- Step 6: Store the unit upright in a dry, well-ventilated place.

SPECIFICATIONS AND PURIFICATION DATA

Specifications

Model	RAD-DIA17HK
Color	White
Product Dimensions(W*D*H)(mm)	420*265*662
Dehumidifying Capacity	MEELS Standard – 17L/Day (26.7℃ 60%) Manufactory's Standard – 28L/Day (30℃ 80%)
Power	AC 220V/50Hz
Plug Type	13A/250V

Purification data

ITEM	Purification
Test laboratory	Intertek Testing Services Shenzhen Ltd. Guangzhou Branch
test method	Based on ANSI/AHAM AC-1-2020
suppression method	More negative ions are produced than positive ones, which can trap dust and bacteria
suppression target	Smoke、Dust、Pollen、PM2.5
test results	Smoke CADR(FT3/Min): 51 Dust CADR(FT3/Min): 64.2 Pollen CADR(FT3/Min): 97.1 PM2.5 CADR(FT3/Min): 57.2
report number	230921139GZU-001

ITEM	Sterilisation
Test laboratory	Intertek Testing Services Shenzhen Ltd. Guangzhou Branch
test method	Based on: GB/T 18801-2022 GB 21551.3-2010 Technical Standard For Disinfection (2002 Ministry of Health P.R.China)-2.1.3
suppression method	Positive and negative ions produce positive and negative ions, positive and negative ion neutralization discharge has a certain bactericidal ability
suppression target	Staphylococcus albicans 8032、Staphylococcus aureusATCC 6538、Escherichia coli 8099
test results	Staphylococcus albicans 8032 Killing Rate: 99.95% Staphylococcus aureusATCC 6538 Killing Rate: 99.95% Escherichia coli 8099 Killing Rate: 99.95%
report number	230921139GZU-002

ITEM	Disinfection
Test laboratory	Intertek Testing Services Shenzhen Ltd. Guangzhou Branch
test method	Based on: GB/T 18801-2022 GB 21551.3-2010 Technical Standard For Disinfection (2002 Ministry of Health P.R.China)-2.1.3
suppression method	Positive and negative ions produce positive and negative ions, positive and negative ion neutralization discharge has a certain bactericidal ability
suppression target	H1N1(A/PR/8/34)
test results	H1N1(A/PR/8/34) Killing Rate: 99.99%
report number	230921139GZU-002

TROUBLESHOOTING

Before calling for service, review the situation below first yourself.

Problem	What to check
Unit does not start	Make sure the dehumidifiers plug is pushed completely into the outlet. Check the house fuse/circuit breaker box. Dehumidifier has reached its preset level or bucket is full. Water bucket is not in the proper position.
Dehumidifier does not dry the air as it should	Do not allow enough time to remove the moisture. Make sure there are no curtains, blinds or furniture blocking the front or back of the dehumidifier. The humidity control may not be set low enough. Check that all doors, windows and other openings are securely closed. Room temperature is too low , below 5 °C (41°F).
The unit makes a loud noise when operating	The air filter is clogged. The unit is tilted instead of upright as it should be. The floor surface is not level.
Frost appears on the coils	This is normal. The dehumidifier has Auto defrost feature.
Water on floor	Hose to connector or hose connection may be loose.
EH(xx), EL(xx), EC(xx), PH(xx), PL(xx), PC(xx) appear in the display	These are error codes and protection codes. See the CONTROL PANEL FEATURES section.

#DetailsMatter