

Model

CR-A142M

CR-A198M

CR-A142SE

CR-A198SE

CR-A249M

CR-A295M

CR-A249SE

CR-A295SE

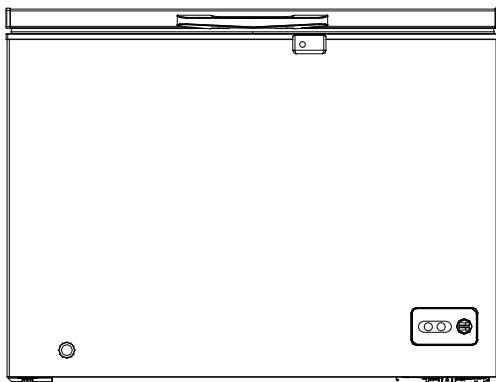

- Thank you very much for purchasing this Toshiba product.
- Read this Owner's Manual and become completely familiar with the product before use in order to use this product safely and correctly.
- Keep this Owner's Manual in a handy place for future reference.
- Make sure that you received your warranty.

Contents

■ Safety warnings

Meaning of safety warning symbols	1
Electricity related warnings	2
Related warnings for use	2
Warnings related to placing items	3
Warnings related to disposal	3

■ Proper use of freezers

Names of components	4
Thermostat	5
Energy saving tips	5
Placement	5
Start	5
Illuminating lamp and replacement	6
Installation guide for handle	6

■ Maintenance of freezers

Cleaning	7
Defrost	7
Stop using	7

■ Frequently asked questions 8

DEAR CUSTOMER:

Thank you for buying this freezer. To ensure that you get the best results from your new freezer, please take time to read through the simple instructions in this booklet. Please ensure that the packing material is disposed of in accordance with the current environmental requirements. When disposing of any freezer equipment please contact your local waste disposal department for advice on safe disposal. This appliance must be only used for its intended purpose.

Safety warnings

This appliance can be used by children aged from 8 years and above and persons with reduced physical sensory or mental capabilities or lack of experience and knowledge if they have been given supervision or instruction concerning use of the appliance in a safe way and understand the hazards involved. Children shall not play with the appliance. Cleaning and user maintenance shall not be made by children without supervision.

This appliance is not intended for use by persons (including children) with reduced physical, sensory or mental capabilities, or lack of experience and knowledge, unless they have been given supervision or instruction concerning use of the appliance by a person responsible for their safety.

Children should be supervised to ensure that they do not play with the appliance.

If the supply cord is damaged, it must be replaced by the manufacturer, its service agent or similarly qualified persons in order to avoid a hazard.

This appliance is intended to be used in household and similar applications such as

- staff kitchen areas in shops, offices and other working environments;
- farm houses and by clients in hotels, motels and other residential type environments;
- bed and breakfast type environments;
- catering and similar non-retail applications.

-WARNING: Keep ventilation openings, in the appliance enclosure or in the built-in structure, clear of obstruction.

-WARNING: Do not use mechanical devices or other means to accelerate the defrosting process, other than those recommended by the manufacturer.

-WARNING: Do not damage the refrigerant circuit.

-WARNING: Do not use electrical appliances inside the food storage compartments of the appliance, unless they are of the type recommended by the manufacturer.

Do not store explosive substances such as aerosol cans with a flammable propellant in this appliance.

Meaning of safety warning symbols



Prohibition symbols

The symbols indicate prohibited matters, and those behaviors are forbidden. Non-compliance with the instructions may result in product damages or endanger the personal safety of users.



Warning symbols

The symbols indicate matters that must be followed, and those behaviors must be strictly executed in line with the operation requirements. Non-compliance with the instructions may result in product damages or endanger the personal safety of users.



Note symbols

The symbols indicate matters to pay attention to, and these behaviors shall be specially noted. Due precautions are needed or minor or moderate injuries or damages of the product will be caused.

This manual contains lots of important safety information which shall be observed by the users.

Safety warnings

► Electricity related warnings

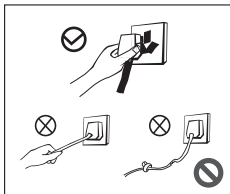

- Do not pull the power cord when pulling the power plug of the freezer. Please firmly grasp the plug and pull it out from the socket directly.
- Do not damage the power cord under any condition so as to ensure safety use, do not use when the power cord is damaged or the plug is worn.
- Worn or damaged power cord shall be replaced in manufacture-authorized maintenance stations.

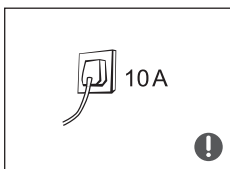

- Please use a dedicated three-hole power socket which is 10 A or more and the power socket shall not be shared with other electrical appliances.
- The power cord should be firmly contacted with the socket or else fires might be caused. Please ensure that the grounding electrode of the power socket is equipped with a reliable grounding line.
- In case of the power plug do not connected to the grounded outlet, please always ensure grounding to the appliance before using.

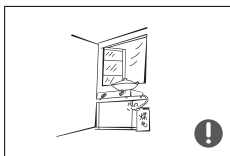

- The freezer adopts 220–240V/50Hz AC power, voltage fluctuations over the range of 220–240V± 10% will cause malfunction or even damage.
- Please turn off the valve of the leaking gas and then open the doors and windows in case of leakage of gas and other flammable gases. Do not unplug the freezer and other electrical appliances considering that spark may cause a fire.

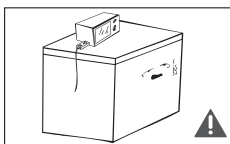

- To ensure safety, it is not recommended that to place regulators, rice cookers, microwave ovens and other appliances at the top of the freezer, those recommended by the manufacture are not included. Do not use electrical appliances in the food pantry.

► Related warnings for use

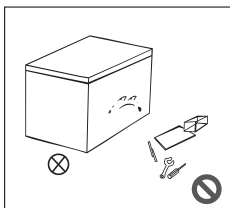

- Authorized demolition or renovation of the freezer is not prohibited. It is forbidden to damage the refrigerant lines and the repair and maintenance of the freezer must be carried out by professionals.
- Damaged power cord must be replaced by the manufacturer, its maintenance department or related professionals in order to avoid danger.

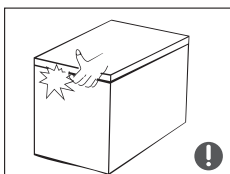

- The surrounding of the appliances around or the embedded structure shall not be obstructed while good ventilation shall be maintained.
- The gaps between freezer doors and between doors and freezer body are small, be noted not to put your hand in these areas to prevent squeezing the finger. Please be gentle when switching off the freezer door to avoid falling articles.
- Do not pick foods or containers in the freezing chamber when the freezer is running, especially metal containers in order to avoid frostbite.

Safety warnings

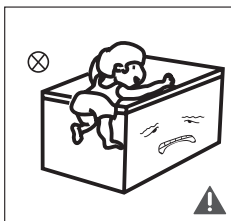

- Do not allow children to enter or climb the freezer to prevent that children are sealed in the freezer or children are injured by the falling freezer.
- Do not spray or wash the freezer, do not fill in the freezer with water ;do not put the freezer in moist places easy to be splashed with water so as not to affect the electrical insulation properties of the freezer.

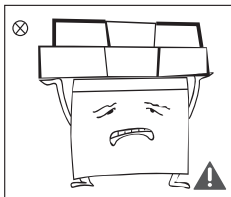

- Do not place heavy objects on the top of the freezer considering that objectives may fall when switching the door, and accidental injuries might be caused.
- Please pull off the plug in case of power failure or cleaning. Do not connect the freezer to power supply within five minutes to prevent damages to the compressor due to successive starts.

► Warnings related to placing items



- Do not put flammable, explosive, volatile and highly corrosive items in the freezer to prevent damages to the product or fire accidents.
- Do not place flammable items near the freezer to avoid fires.

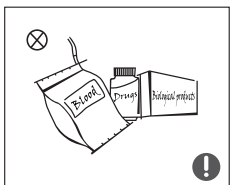

- This product is household freezer and shall be only suitable for the storage of foods. Household freezers shall not be used for other purposes, such as storage of blood, drugs or biological products.

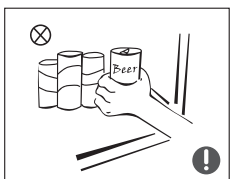

- Do not place items such as bottled or sealed container of fluid such as bottled beers and beverages in the freezer to prevent bursts and other losses.

► Warnings related to disposal



The freezer's refrigerant and cyclopentane foam materials are combustible materials and discarded freezers should be isolated from fire sources and can not be burned. Please transfer the freezer to qualified professional recycling companies for processing to avoid damages to the environment or other hazards.



Please remove the door of the freezer and shelving basket which shall be properly placed to avoid accidents of children entering and playing in the freezer.

Proper use of freezers

► Names of components

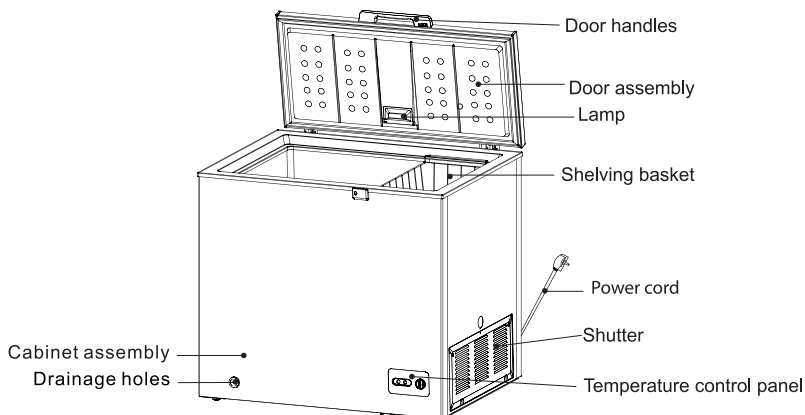

- The low temperature of freezer may keep food fresh for a long time and it is mainly used to store frozen foods and making ice.
- The freezer is suitable for storage of meat, fish, shrimp, dumplings, rice balls and other foods not to be consumed in short term.
- Chunks of meat are preferably to be divided into small pieces for easy access.
Please be noted food shall be consumed within the shelf time.



The features and accessories of the freezer you bought may be not entirely consistent with the legend, please refer to the object.

► Product features

- Reliable properties: the freezer adopts branded efficient compressor which has excellent performance and high reliability;
- Foam door structure;
- Environmentally friendly refrigerant and cyclopentane environmentally friendly blowing agents are used to promote environmental protection.

Proper use of freezers

► Thermostat

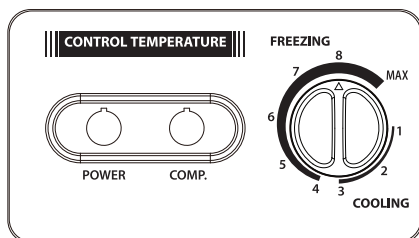

- Connect the freezer to power supply and "Power" indicator (the green light) will shine. "COMP." indicator (the red light) will shine in operation.
- The temperature of the chamber is adjusted through the thermostat knob. The number "1, 2, 3, 4, 5, 6, 7, 8" do not mean a specific temperatures, the lower number is the higher temperature inside freezer, while the higher number is the lower temperature. The user can choose the right temperature zone according to their needs.
- When the temperature controller is adjusted to 1-3 gears, the freezer will stay in refrigerated state; to 4-8 gears, will stay in the coldest temperature state.

■ Information : When using in refrigerated state, dewing might be generated inside compartment as natural phenomenon.



The indicator of the freezer you bought may be not entirely consistent with the legend, please refer to the object.

► Energy saving tips

The appliance should be located in the coolest area of the room, away from heat producing appliance or heating ducts, and out of the direct sunlight.

- Let hot foods cool to room temperature before placing in the appliance. Overloading the appliance forces the compressor to run longer. Foods that freezer too slowly may lose quality, or spoil.
- Be sure to wrap foods properly, and wipe containers dry before placing them in the appliance. This cuts down on frost build-up inside the appliance.
- Appliance storage bin should not be lined with aluminum foil, wax paper, or paper toweling. Liners interfere with cold air circulation, making the appliance less efficient.
- Organize and label food to reduce door openings and extended searches. Remove as many items as needed at one time, and close the door as soon as possible.

► Placement

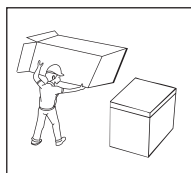

- Before using the freezer, remove all packaging materials including bottom cushions and foam pads and tapes inside the freezer, tear off the protective film on the door and the freezer body.

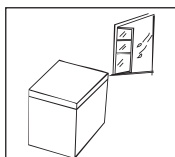

- The freezer is placed in a well-ventilated indoor place; the ground shall be flat, and sturdy.

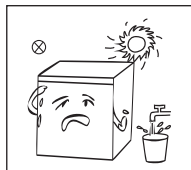

- Keep away from heat and avoid direct sunlight. Do not place the freezer in moist or watery places to prevent rust or reduction of insulating effect.

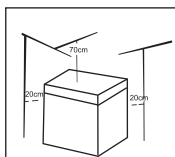

- The top space of the freezer shall be greater than 70 cm., and the distances from both sides and backside shall be more than 20 cm. to facilitate the opening and closing and heat dissipation.
- Wipe the freezer inside and outside with warm moist rag (add a small amount of detergent in the warm water and wipe clean finally with clean water).

► Start

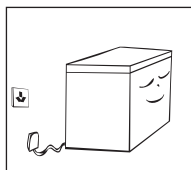

- The freezer shall stay for half an hour before connecting 220~240V/50Hz power when it is firstly started.
- The freezer shall run 2 to 3 hours before loading fresh or frozen foods; the freezer shall run for more than 4 hours in summer in advance considering that the ambient temperature is high.

Proper use of freezers

► Illuminating lamp and replacement

Lamp replacement by professionals.

► Installation guide for handle

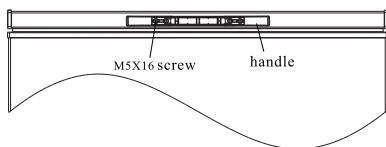

1. Hold the handle with the left hand, and aim its mounting hole at the mounting hole of the door. Insert the key into the keyhole with the right hand, and then turn the key clockwise to drive the rotation of the lock hook. Meanwhile, adjust the position of the handle from side to side in a proper manner to ensure the lock hook can hook the lock loop in locked state. Afterwards, fix the handle to the door with four M5X16 screws.

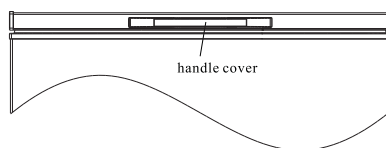

2. Install the handle cover.



The above pictures are for assembly reference only, handles are slightly different for different product.

Maintenance of freezers

► Cleaning

- Dusts behind the freezer and on the ground shall be timely cleaned to improve the cooling effect and energy saving. The interior of the freezer should be cleaned regularly to avoid odor. Soft towels or sponge dipped in water and non-corrosive neutral detergents are suggested for cleaning. The freezer shall be finally cleaned with clean water and dry cloth. Open the door for natural drying before the power is turned on.



- Do not use hard brushes, clean steel balls, wire brushes, abrasives, such as toothpastes, organic solvents (such as alcohol, acetone, banana oil, etc.), boiling water, acid or alkaline items clean freezer considering that this may damage the fridge surface and interior.
- Do not rinse with water so as not to affect the electrical insulation properties. Please use a dry cloth when cleaning temperature control knob and electrical components.

⚠ Please unplug the freezer for defrost and cleaning.

► Defrost

- Freezer shall be manually defrosted.
Unplug the freezer and open the freezer door, remove foods and drawers before defrosting; Open the outflow holes and drainage holes (and place water container at the outflow holes); indoor frost will naturally melt, wipe the defrost water with a dry, soft cloth. When the frost softens, an ice scraper might be used to the accelerate de-icing process.
- Please remove the food and put in a cool place when defrosting before removing accessories.

Other mechanical devices or other means shall not be used to accelerate except those recommended by the manufacturer. Do not damage the refrigerant circuit.

► Stop using

Foods can be preserved for a couple of hours even in summer in case of power failure; it is recommended to reduce the frequency of opening door and do not put fresh foods into the freezer.

Please unplug the freezer left unused for a long time for cleaning. Keep the door open to avoid the bad odor.

Do not turn upside, horizontally place or vibrate the freezer, the carrying angle can not be greater than 45°. Please hold the door and hinge when moving.

⚠ Continuous operation is recommended when the freezer is started. Please do not move the freezer under normal circumstances so as not to affect the freezer's service life.

Frequently asked questions

- The following simple issues can be handled by the user. Please call the after-sale service department if the issues are not settled.

Inoperation	Whether the freezer is plugged and connected to power; Low voltage; Whether temperature control knob is in the work area; Failure power or tripping circuit.
Odor	Odorous foods should closely wrapped; Whether foods are rotten; Whether the interior shall be cleaned.
Long-term operation of compressor	It is normal that freezer operates for longer time in summer when the ambient temperature is higher; Do not put too much food in the freezer at one time; Do not put foods until they are cooled; Frequent opening of freezer door; Thick frost layer (defrost is needed).
Illuminating light does not shine	Whether the freezer is connected to power; Whether the indicator light is damaged.
The freezer door can not be properly closed.	The freezer door is stuck by food packages; Too much food; Tilt freezer.
Loud noises	Whether the food is leveled; Whether the freezer is balanced; Whether the freezer parts are properly placed.
Transient difficulty in door opening	After refrigeration, there will be pressure difference between the inside and outside of the freezer to result in transient difficulty in door opening. This is a normal physical phenomenon.

Warm tips:

- ◆ The freezer enclosure may emit heat during operation specially in summer, this is caused by the radiation of the condenser, and it is a normal phenomenon.
- ◆ Condensation: condensation phenomenon will be detected on the exterior surface and door seals of the freezer when the ambient humidity is large, this is a normal phenomenon, and the condensation can be wiped away with a dry towel.
- ◆ Airflow sound: Refrigerants circulating in the refrigerant lines will produce eruption of sound and grunts which is normal does not affect the cooling effect.
- ◆ Buzz: Buzz will be generated by running compressor specially when starting up or shutting down.
- ◆ Clatter: The solenoid valve or electric switch valve will clatter which is a normal phenomenon and does not affect the operation.

TOSHIBA