

**TOSHIBA**



**Toshiba Electric  
Rice Cooker/Warmer**

(For household use)

# Instruction Manual

Model

**RC-10NMF  
RC-18NMF  
RC-10NMFI  
RC-18NMFI**



# Safety caution

## Caution

Do not disassemble, repair or modify.

Do not immerse the appliance in water.

Do not attempt to use the metal articles, e.g. a pin or a wire, into the hole.

Do not use when the power supply cord or the power plug is broken, or the power plug is loose.

Do not directly touch the steam with your hand or face.

When disconnecting, hold the power plug and pull it out without touching the power supply cord.

Pull the power plug from the AC outlet when not in use.

Do not place the appliance on the hot, soft, or unstable surface.

Do not use the appliance near fire or water source.

Do not use any other inner pot except the provided one.

Holding the power plug while retracting the power supply cord.

Do not use the appliance in the place which is about 10 cm near the wall, on the paper, clothes, a carpet, or a plastic bag, etc. and the place exposed to direct sunlight.

Wipe away the drops of water and the foreign matter after use.

Do not cover the steam vent with the cloth or place anything while operating.

Do not use the metal spatula, metal-scrubbing brush, nylon-scrubbing brush, and cleanser with the inner pot.

Do not use the appliance near the flammable place or an electromagnetic wave adjuster.

This appliance is not intended for use by young children or infirmed persons unless they have been adequately supervised by a responsible person to ensure they can use the appliance safely.

Do not allow the children to use, keep it out of reach from them.

If the power plug or its polar is dusty, wipe it away with the dry cloth.

Fully fit the power plug into the socket.

Do not open the lid while cooking.

Do not break/scratch, bend, pull, twist, the power supply cord.

Do not place the appliance near the heating source.

Do not put the heavy objects, pinch, or modify the power supply cord.

Do not connect the power supply cord while your hand is wet.

Right after use or while using, do not touch the hot part (e.g. the inner part of the outer lid, a heating plate, a steam vent, or the inner pot)

Do not use the appliance near the wall or the furniture.

Do not touch the hook button while moving the appliance.

Do not move the appliance while cooking.

Do not warm rice with the spatula inside inner pot.

Do not cooking if the inner pot is not inside the appliance.

Unplug the power cord before cleaning the appliance.

Do not warm rice over 30 hours. It is greater than standard of warming time, the indicator flashing.

This appliance is not intended for use by persons (including children) with reduced physical, sensory or mental capabilities, or lack of experience and knowledge, unless they have been given supervision or instruction concerning use of the appliance by a person responsible for their safety.

Children should be supervised to ensure that they do not play with the appliance.

This appliance is intended to be used in household and similar applications such as:

- staff kitchen areas in shops, offices and other working environments;
- farm houses;
- by clients in hotels, motels and other residential type environment;
- bed and breakfast type environment.

If the power supply cord is damaged, it must be replaced by the manufacturer, its service agent or similarly qualified persons in order to avoid a hazard.



# Part names

## Body

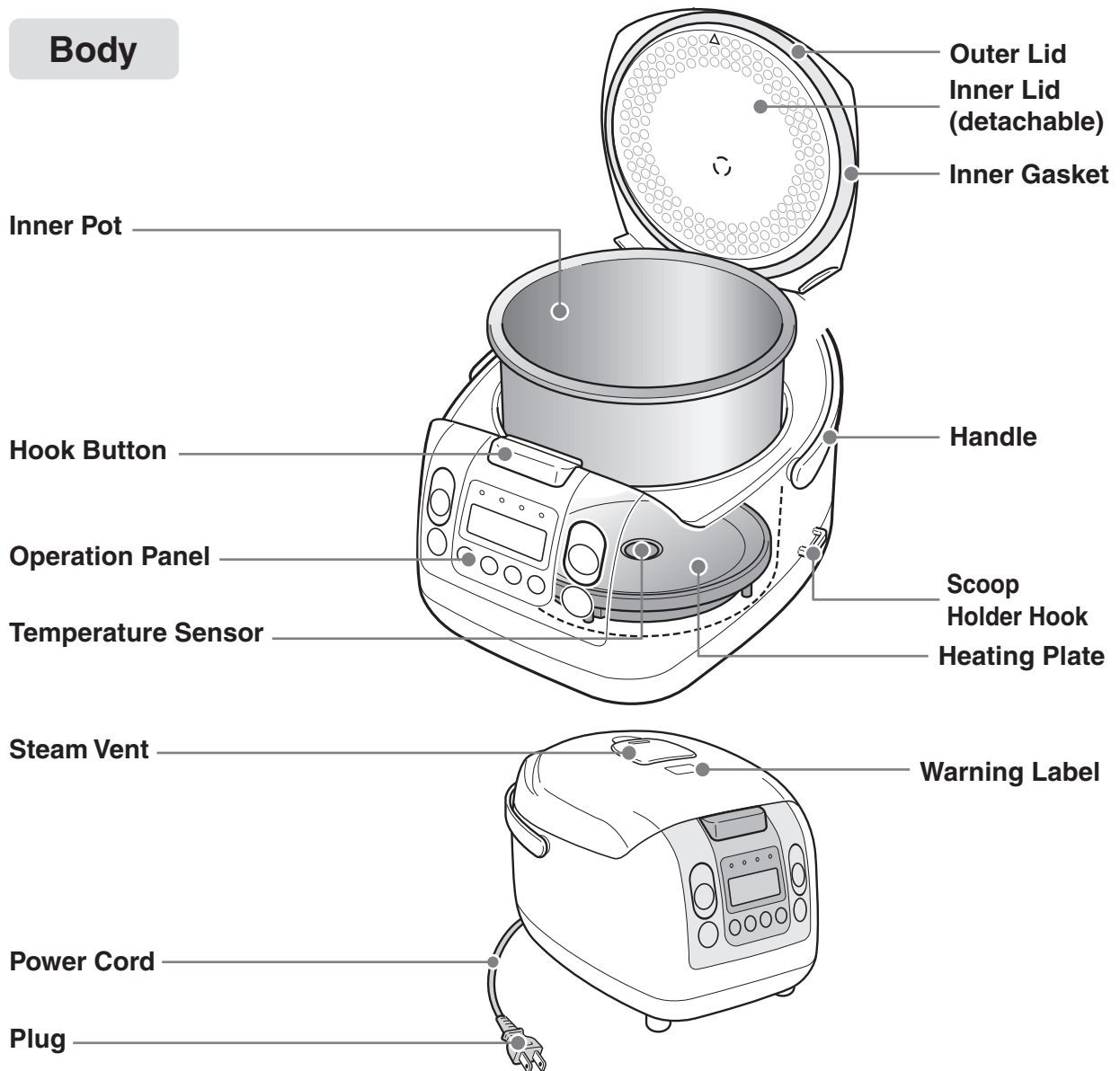

## Accessories



Measuring Cup  
(Approx. 180 ml.)



Scoop holder  
Insert it in the hook on the cooker's side.



Scoop

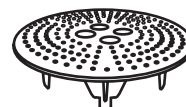

Food Steamer



# Part names

## Control Panel

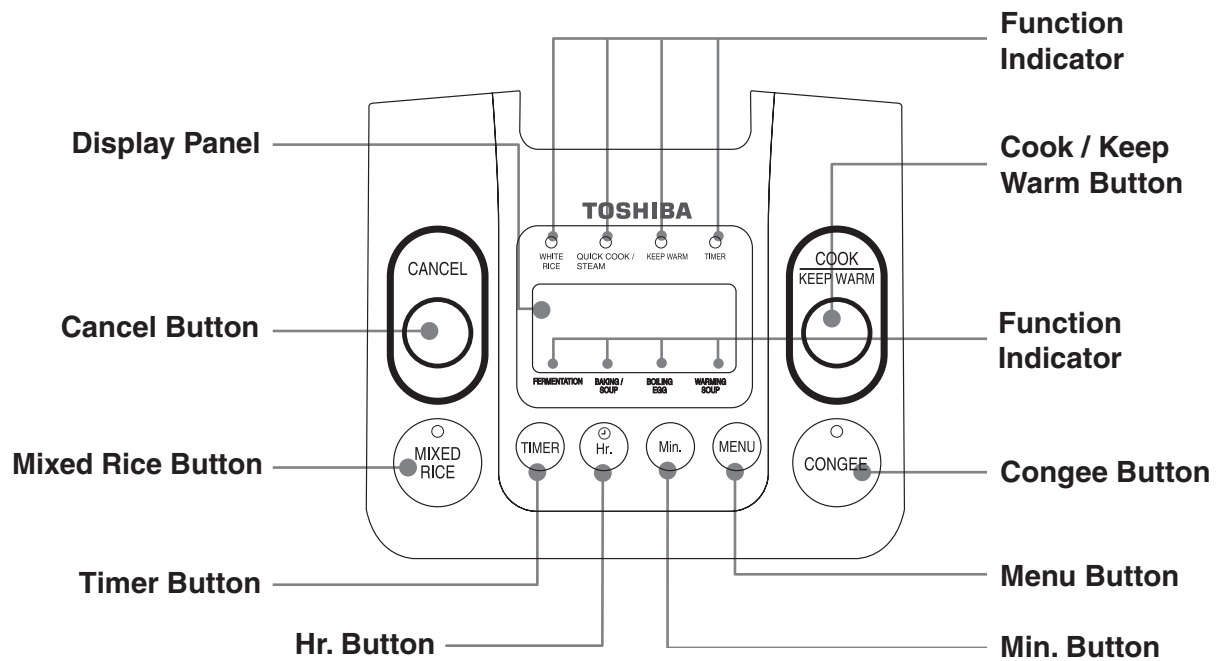

## Rice Cooker - Cooking Time

Cooking	Button	Water Level Scale	Type 1.0 L		Type 1.8 L	
			Amount of Rice (Cup)	Standard Cooking Time (Minutes)	Amount of Rice (Cup)	Standard Cooking Time (Minutes)
White Rice	COOK	White Rice	1-5.5	38-51	2-10	42-54
White Rice (Rapid Cook)	COOK (Press twice)	White Rice	1-5.5	34-43	2-10	38-46
Mixed Rice	MIXED RICE	Mixed Rice	1-5.5	44-48	2-10	45-58
Glutinous Rice	COOK	Glutinous Rice	1-3	37-46	2-6	39-46
Congee	CONGEE	Congee	0.5-1	76-80	1-3	78-83



# Preparation

- 1 Measure the rice with the measuring cup provided.**  
 ● A flat-filled cup of rice is approx. 180 ml.



- 2 Quickly rinse the rice until the water becomes clear.**

- ① Firstly, fill enough water and mix the rice and water and rinse the rice, then pour out the water immediately.  
 ② Scrub and rinse the rice repeatedly with water until the water becomes reasonably clear.

◆ The rice can be rinsed in the inner pot.

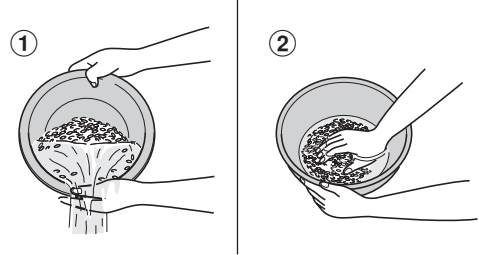

- 3 Fill in or pour out water according to the water level scale of the cooking means you want.**

- Please level the surface of the rice and fill in or pour out water on a flat surface.  
 ● Fill in or pour out water according to the cooking means and the cups of the rice. And adjust the amount of water according to the type of the rice and your personal taste.

◆ Example: Cooking 3 cups of rice.

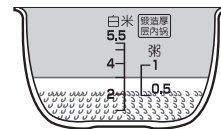

- 4 Place the inner pot inside the body and close the outer lid.**

- Please wipe away the water drops and dirt on the outer of the inner pot, the temperature sensor, the cooking heating plate and the inner lid.  
 ● In order to make the inner pot close contact the cooking heating plate, please turn the inner pot twice or three times in the directions as shown by the arrows.  
 ● Make sure that the steam vent works properly.

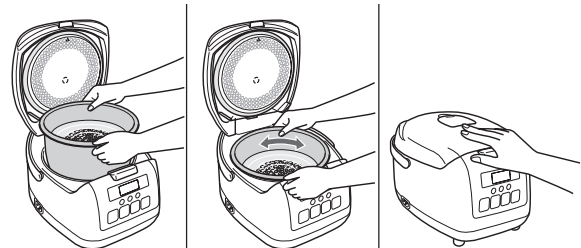

- 5 Fit the power plug into the socket.**

- Please hold the plug while fit or remove the power plug into the socket.

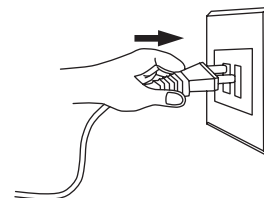

- 6 Make sure that the time on the display window was set precisely with the present time.**



# How to adjust the clock

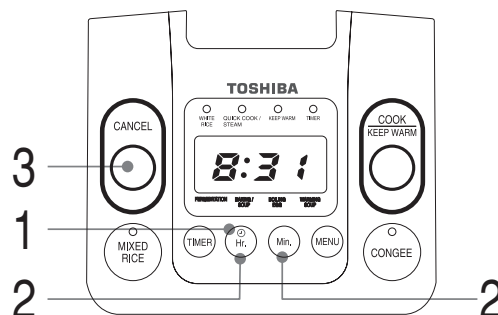

**Example: To adjust the current time to 8:31 a.m.**

## Procedure

- 1** Hold down the Hrs button for more than 1 second.

▼ The clock display flashes.



- 2** Press the Hrs button to adjust the Hour readings and press the Min button to adjust the Minute readings.
  - For Min button, if the button is held down and not released the setting pace will be 10 minutes.

▼ The clock display flashes.



- 3** Press the CANCEL button.  
Clock adjustment is complete and the time counts.

▼ The clock display unflashes.



## NOTE

- The lithium battery installed inside the cooker will last for 4-5 years at the room temperature of 20°C with the power plug connected. With the lithium battery, the current time can still display and the set time is still stored in the memory even though the power plug is disconnected. If the display lights off or 0:00 flashes on the display, it means that the battery expired.  
Even if the current time and the set time disappear, the cooker can cook rice as usual.  
(Pressing CANCEL button will stop the flashing of 0:00.)  
Never drop the lithium battery into water or charge, disassemble or heat it.
- The clock cannot be set during COOK, WARM and TIMER mode.
- The clock cannot be set if the power plugs (at the power supply side and the body side) are not fully inserted.
- While the clock display is flashing, the clock will not go ahead.
- Time display is 24 Hrs.
- In the operation of the Hrs button, at 0:00 the sound “beep luo luo” will be heard and at 12:00 the sound “beep luo luo” will be heard twice. In the operation of the Min button, the sound “beep luo luo” will be heard at 00 minute and the long “beepee” sound will be heard at 10, 20, 30, 40 and 50 minutes.



# How to preset time

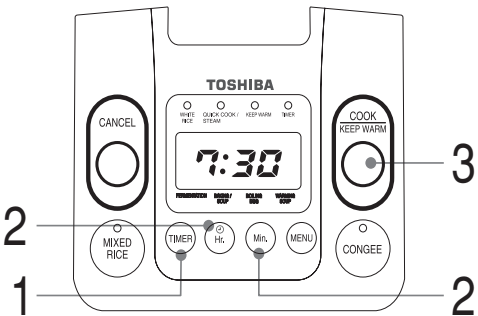

Example: To set the timer for preset time to finish at 7:30 a.m.

Procedure	<div>1</div> <div>Press the <b>TIMER</b> button.</div> <div><div>▼ The TIMER indicator flashing.</div><div>▼ The last preset timer flashing.</div></div> <div><div></div><div></div></div>
	<div>2</div> <div>Press the <b>Hrs button and Min button to adjust the preset time.</b><div><ul style="list-style-type: none"><li>● If the preset time is the same as the last one, this step can be omitted.</li><li>● Time display is 24 Hrs.</li><li>● Minute button will be added every 10 minutes.</li></ul></div></div> <div><div><div>▼ The TIMER indicator flashing.</div><div>▼ The preset time in setting.</div></div><div><div></div><div></div></div></div>
	<div>3</div> <div>Press the <b>COOK</b> button.</div> <div><div><ul style="list-style-type: none"><li>● For cooking as cooking menu selected.</li><li>● During preset time, hold down the Hrs button to display the current time.</li></ul></div><div><div>▼ The COOK indicator lights up.</div><div>The TIMER indicator lights up.</div><div>▼ The preset time for this time.</div></div><div><div></div><div></div></div><div>The timer is set up successfully.</div></div>
Cooking Done	<div><div>The “Beep” sounds for 5 times</div><div>▼ The KEEP WARM indicator lights up.</div></div> <div><div></div><div></div></div> <div>Warming</div> <div><div>▼ The time that has elapsed for warming.</div><div>( h : hour)</div></div>









# How to cook

(White Rice, Mixed Rice, Quick Cook and Congee)

**NOTE**

■ **For rapid cook only.**

- Rapid cook refers to the cooking method that first shortens the cooking time. Generally, the rice cooked by this method tastes firmer and has a little water on its surface.
- Use this method when the amount of rice is less than 4 cups for Type 1.0L and 6 cups for Type 1.8L.

Procedure	<p><b>Press the COOK button once.</b></p> <ul style="list-style-type: none"><li>● For rapid cook, please press this button twice.</li><li>● In rapid cook, the rapid Indicator will light up.</li></ul>	<p>▼ The COOK indicator lights up.</p> 	<p>▼ Current time</p> 
	<p><u>cooking</u></p> <ul style="list-style-type: none"><li>● In rapid cook, the rapid Indicator will flash.</li><li>● In rapid cook, the time will show 8 minutes ahead.</li></ul>	<p>▼ The COOK indicator is flashing.</p> 	<p>▼ The time (in minutes) remains for cooking.</p> 
Cooking Done			
	<p><u>Steaming</u></p>	<p>After "Beep" sounds for 5 times ▼ The KEEP WARM indicator will light up.</p> 	<p>▼ The time that has elapsed for warming. ( h : hour)</p> 





# How to cook (Fermentation, Baking/Soup, Boiling Egg and Warming Soup)

## Example : Ferment cooking

### Procedure

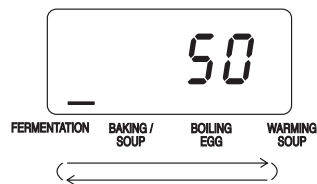
#### 1 Select (Fermentation) press button



- Select cooking menu by MENU button.
- COOK indicator will flashing.
- During press button MENU, screen displays menu (  ) running change will occur.

#### 2 Set time cooking by press button

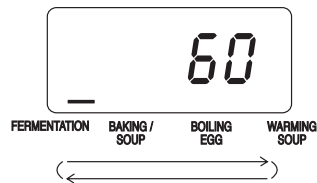

(Sample time setting 60 minutes)

- If the Min button is held down and not released the time setting will be added 10 minutes.

#### 3 Start (Cooking) press button

▼ Screen displays cooking

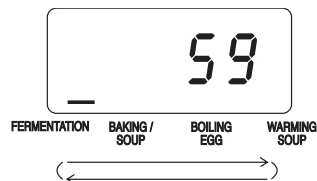

- The COOK indicator light up.
- The remaining time for cooking show 59 minutes.

### Cooking Done

**When cooking is finished, it sounds (Beep) for 5 times.**  
The machine will be cut off automatically.



# How to keep warm

Cooked rice will run into warming automatically.

## Start warming

Keep warm function

Press button  to warming



- The keep warm and reheat indicator will light up.
- Screen displays running time.  
( h : hour)

## Stop warming

Stop

Press button  to cancel keep warm function.

- The keep warm indicator will light off.

### NOTE

- During warming or reheat function press hour button, screen will display present time.
- Do not warm and leave scoop in pot. Because it causes smell or color changeable.
- Do not warm rice over 30 hours. It is greater than standard of warming time, the indicator flashing and shown 30 hours.



- Use warming menu for rice which is less than half of pot. If rice is over, heat is not unsuitable.
- Rice is extremely hard, pouring water for 1-2 teaspoon can solve this problem. Rice will be soft.
- Do not heat cold rice because heat is not unsuitable.



# Maintenance and Specification

## Maintenance

### How to detach

- 1 Hold the holders at the bottom edges of the inner gasket and pull it towards you.

- Do not detach the inner gasket if it is not necessary because it may be loose.

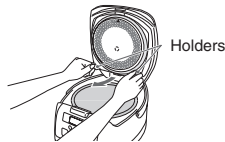

### How to reassemble

- 1 Fit the upper part of the inner gasket to the slot on the outer lid.

- Hold the holders and lift the inner gasket up following the direction of the  $\Delta$  mark fit it to reassemble.
- Reassemble only when the inner gasket is completely dry.

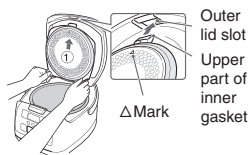

- 2 Push the holders to the outer lid firmly.

- Ensure the inner gasket fit firmly to the outer lid. If it does not, the outer lid cannot be closed.

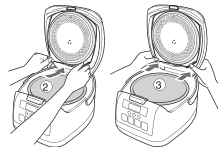

- Please clean the inner gasket after cooking the rice.
- Do not bend or twist the inner gasket. It may not fit to the outer lid or the steam may leak out.

## Steam Vent

### How to detach

- 1 Turn the steam vent cap following the arrow direction.

- Open the cap by turning it upwards.

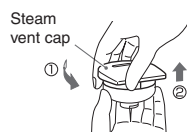

### How to reassemble

- 2 Close the cap by aligning the mark with the groove, then turn the cap following the arrow direction.

- Turn the cap until the clicking sound is heard.

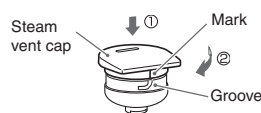

### After cooking rice

Clean them with a sponge and mild dish detergent.

Clean it with a sponge and mild dish detergent.

- Clean the inner gasket as well.

Wash the steam vent thoroughly.

Wipe away the dirt and stain with a damp cloth.

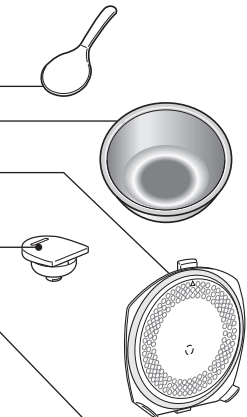

### When dirty

Wipe away the dirt and stain with a damp cloth.

- Do not wash the pot body thoroughly.
- Do not wet.
- Do not wet the control panel and the outer lid.
- Do not pour the water directly to the pot.

If there is some grains stuck on the heating plate firmly, rub it off with fine sandpaper (No. 600).

Remove some grains of rice with a cotton bud.

Remove some dirt with a cotton bud.

**Caution :** To prevent damage to the appliance do not use alkaline cleaning agents when cleaning, use a soft cloth and mild detergent.

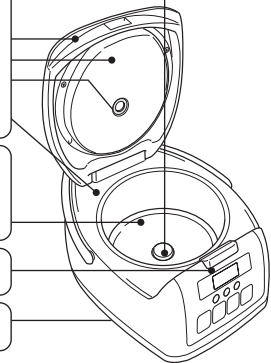

## Specifications

Model	Power Supply	Power Consumption (W)	Dimension (Cm)			Weight (Kg)
			Width	Depth	Height	
RC-10	220 - 240 V ~ 50-60 Hz	600, 560*	25.5	32.8	21.5	3.7
RC-18		750, 680*	28.0	35.2	24.9	4.5

\* Power supply 220 V ~ 50 Hz



**TOSHIBA**

NRNL10000000013