

USER MANUAL

**ELECTRIC FAN
F-DSC35SG(W)**

TOSHIBA



CONTENTS

SAFETY INSTRUCTIONS	01
PRODUCT INTRODUCTION.....	04
INSTALLATION INSTRUCTION	05
OPERATING INSTRUCTION	07
SPECIFICATIONS.....	10
CLEANING ANDMAINTENANCE	10
TROUBLESHOOTING.....	10

Thank you very much for purchasing Toshiba electric fan.

- In order to use this fan correctly and safely, please carefully read this instruction manual to fully understand the content before using it.
- Keep this owner’s manual in a handy place for future reference..

SAFETY INSTRUCTIONS

Safety precautions







Always follow these instructions!

This manual provides instructions that must be observed when using the fan in order to prevent danger to the user, other persons, and property.

CAUTION

Read Rules for Safe Operation and Instructions Carefully.

WARNING











	If the supply cord is damaged, it must be replaced by manufacturer or its service agent or a similarly qualified person in order to avoid a hazard.
	Indoor use only.
	To protect against the risk of electrical shock, do not immerse the unit, cord or plugin water or other liquid.
	This appliance is not intended for use by persons (including children) with reduced physical, sensory or mental capabilities, or lack of experience and knowledge, unless they have been given supervision or instruction concerning use of the appliance by a person responsible for their safety. Children should be supervised to ensure that they do not play with the appliance.
	When the appliance is not in use and before cleaning, unplug the appliance from the outlet.
	Keep electrical appliances out of reach from Children or infirm persons. Do not let them use the appliances without supervision.

SAFETY INSTRUCTIONS

1. Never insert fingers, pencils, or any other object through the grille when fan is running.
2. Do not place the fan near the window, or the rainy day may cause electric shock.
3. Household use only.



NOTE

- This section describes the content and importance of safety matters to prevent personal injury or property damage to users or others. Please read the text with a full understanding of the following content, and be sure to abide by the safety precautions described.

 Prohibited	It is prohibited to tilt manually when horizontal oscillator is activated.
 Warning	Do not connect the power supply until the product is installed.
 Warning	Cut off the power supply before moving the product.
 Warning	Make sure the product is disconnected from the power supply before removing the protective casing.
 Warning	Do not plug or unplug the power plug with wet hands to avoid the risk of electric shock.
 Warning	When the product is running, do not put your fingers or sharp objects into the grille.
 Warning	Avoid using it near acid-base oils, insecticides, curtains and other items.
 Warning	Avoid use in direct sunlight or high humidity environments for long periods of time.
 Warning	It is prohibited to use it in places where there are hanging objects that are easy to fall, where it is susceptible to impacts, or where the placement is unstable. The product should be placed stably when using it, please do not tip over or tilt.
 Warning	Only the matching adapter can be used. Do not use other adapters so as to avoid danger.

SAFETY INSTRUCTIONS

 Matters that may cause minor injury or property damage

 Warning	Before use, please check whether the voltage used is the same as the voltage marked on the product.
 Warning	When you leave the machine or when the machine is not in use, turn off the power and unplug the power plug to avoid circuit failure and accidents.
 Warning	Before use, check whether the power cord and plug are damaged. If the power cord is damaged, it must be replaced by the manufacturer, its maintenance department or a specialist from a similar department in order to avoid danger.

PRODUCT INTRODUCTION

Parts name

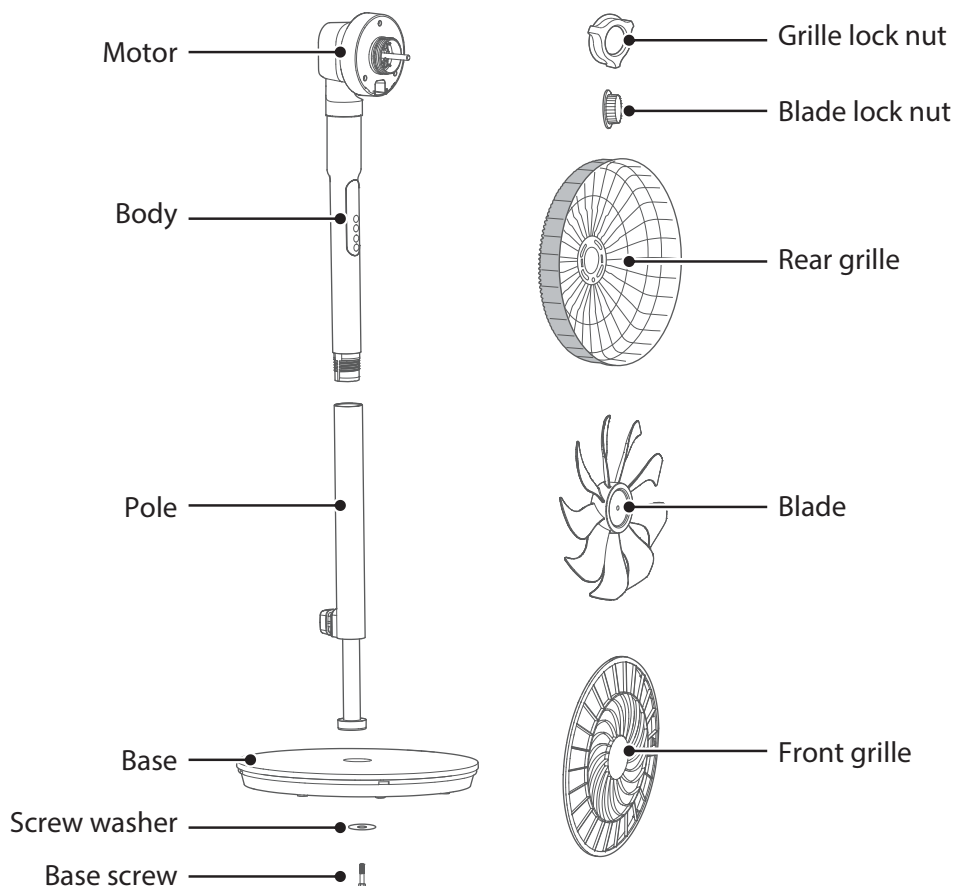

INSTALLATION INSTRUCTION

Preparation for installation

⚠ ATTENTION

Before installation, please rotate the grille lock nut counterclockwise from the head thread and take it out.

1 Assembly of base

Align the pole and the base and secure them with base screw and screw washer.

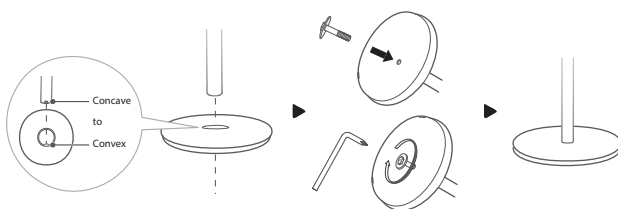

2 Assembly of body and pole

First align the holes of the body and the pole, and then rotate clockwise to fix them.



3 Assembly and lock of rear grille

Align the head and the rear grille, hang it up and lock it with the grille lock nut.

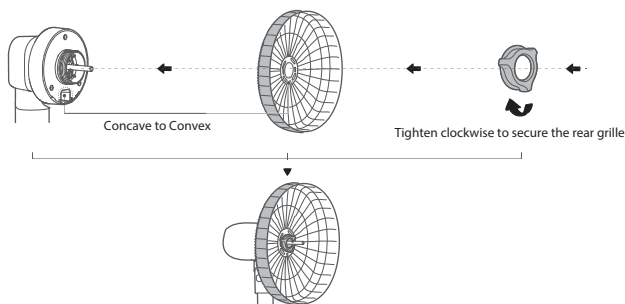

INSTALLATION INSTRUCTION

4 Assembly and lock of blade

Align and thread the fan blade with the motor shaft, and then lock the fan blade with the blade lock nut.

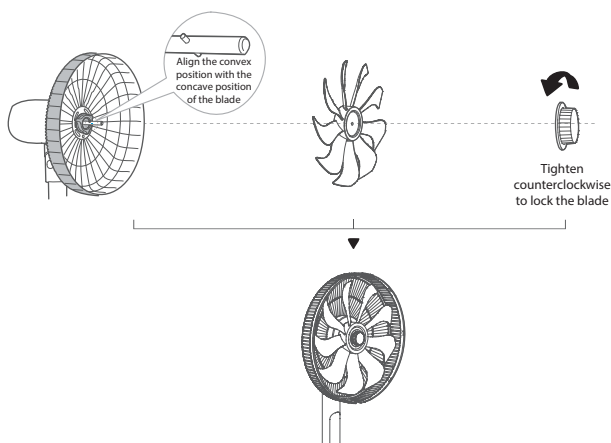

5 Assembly and lock of front grille



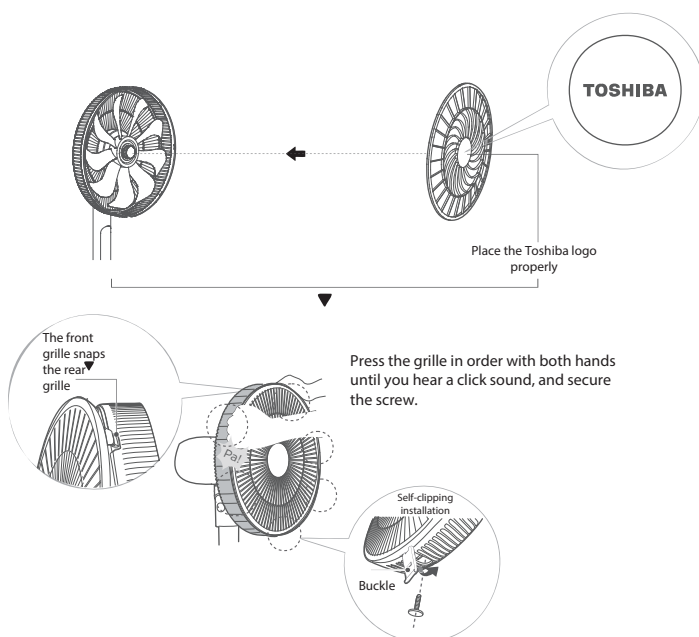



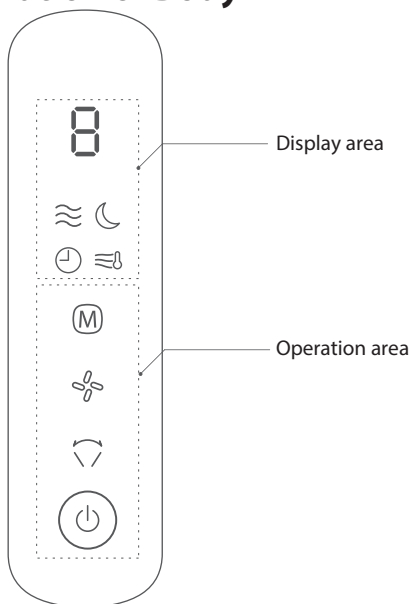

Locate the front grille buckle and align the Toshiba logo.



OPERATING INSTRUCTION

Instructions for Operation of Body



Function	Operation instruction
	<ol style="list-style-type: none"> 1. In power off state, press it to enter the power on state. 2. In power on state, press it to enter the power off state.
	Adjust wind speed.
	To set the oscillator operation, press to cycle the oscillator among (60°) → (stop) → (90°) → (stop) → (120°) → (stop).
	To switch the wind mode, press to cycle among normal → AI → sleep.
	<ol style="list-style-type: none"> 1. In power on state, the current wind speed is displayed; when the oscillator is set, the oscillator grade is displayed; when the scheduled power off is set, the power off time will be displayed. 2. In power off state, press it to enable the scheduled power on function, the power on time will be displayed. 3. E1 displays when there is short circuit fault; E2 displays when there is temperature sensor fault.
	Normal mode indicator light
	Sleep mode indicator light
	AI mode display light
	<ol style="list-style-type: none"> 1. In power off state, this icon will light up when the scheduled power-on is enabled. 2. In power on state, this icon will light up when the scheduled power-off is enabled, otherwise it will go out.

OPERATING INSTRUCTION

Instructions for Operation of Body

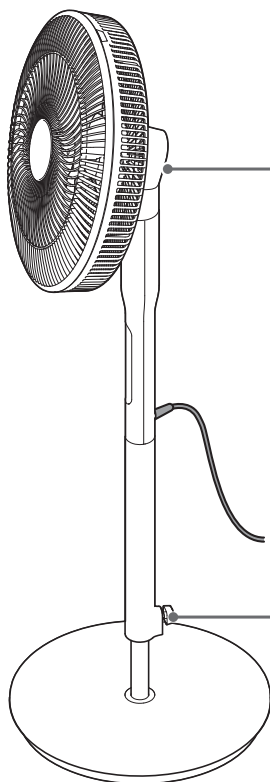

When adjusting the wind direction

Adjust left
and right

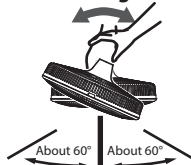

Adjust up and
down

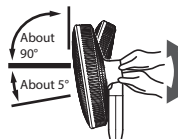

※ Please be careful not to get your fingers caught in the movable part when adjusting.

When adjusting the height

- ① Please unplug the adapter from the socket first and cut off the power supply.
- ② Adjust the height adjustment lever while holding the pole.

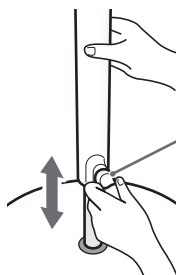

Height adjustment lever

(For safety reasons, the operation force has been slightly strengthened.)

※ Please be careful not to get your fingers caught in the movable part when adjusting.





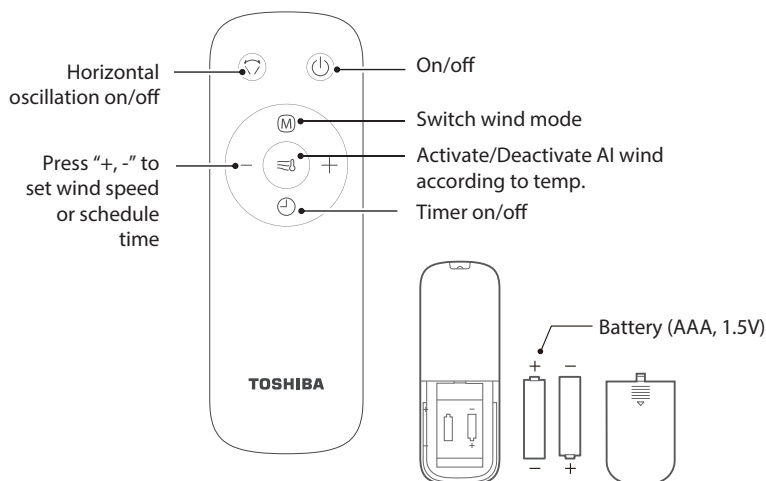

OPERATING INSTRUCTION

Instructions for Remote Control

Note

- The remote control should be normally used within 5 meters of the front of the product and 30° of the deviation angle.
- The battery contains many heavy metals, acids and bases, etc., which may threaten human's health. Waste batteries should be recycled separately.



Function	Operation instruction
	To set the oscillator operation, press to cycle the oscillator among (60°) → (stop) → (90°) → (stop) → (120°) → (stop).
	<ol style="list-style-type: none"> 1. In power on state, press it to set the scheduled power-off state, or adjust the scheduled time, with a maximum setting of 8 hours. 2. In power off state, press it to set the scheduled power-on state, or adjust the scheduled time, with a maximum setting of 8 hours.
	<ol style="list-style-type: none"> 1. In power on state, press it to turn on/off the AI wind. 2. It will changes the wind speed according to the room temperature.
	<ol style="list-style-type: none"> 1. In power on state, press it to increase the wind speed. 2. In timer setting state, increase the timing value.
	<ol style="list-style-type: none"> 1. In power on state, press it to decrease the wind speed. 2. In timer setting state, reduce the timing value.
	<ol style="list-style-type: none"> 1. In power off state, press it to enter the power-on state. 2. In power on state, press it to enter the power-off state.
	To switch the wind mode, cycle among normal → AI → sleep.

SPECIFICATIONS

Model	Rated input	Rated Voltage (V~)	Rated power (W)	Noise dB(A)	Standby power (W)	Unit Dimensions
F-DSC35SG(W)	100-240V- 50/60Hz 1.5A	24V	11	55	0.8	400x370x1080-1180

CLEANING AND MAINTENANCE

The fan requires little maintenance. Do not try to repair it by yourself. Refer it to qualified service personnel if service is needed.

1. Before cleaning and assembling, unplug the fan from the power supply.
2. To ensure adequate air circulation to the motor, keep vents at the rear of the motor free of dust. Do not disassemble the fan to remove dust.
3. Please wipe the exterior parts with a soft cloth soaking a mild detergent.
4. Do not use any abrasive detergent or solvents to avoid scratching the surface. Do not use any of the following as a cleaner: gasoline, thinner.
5. Do not allow water or any other liquid into the motor housing or interior parts.
6. Plastic parts should be cleaned with a soft cloth moisten with mild soap. Thoroughly remove soap with dry cloth.

TROUBLESHOOTING

In the case of any abnormality when using this fan, please check the following points before requesting repair.

Trouble	Check the following
The blades do not rotate.	<ul style="list-style-type: none">• Is the Fan blade installed properly?• Is the power plug properly inserted into the outlet?• Are any of the blades contacting guard?
The blades spin but make a strange sound.	<ul style="list-style-type: none">• Is the spinner properly holding the blades in position?• Are the front and rear guard sections properly mounted?• Are any of the blades contacting guard? <div>• Are the blades and guard clean?</div>

#DetailsMatter